

2013 COMPREHENSIVE PLAN AND DOWNTOWN PLAN UPDATE
CITY OF OTTAWA, IL

SECOND PUBLIC FORUM SEPTEMBER 16, 2013

Prime Consultant and Lead Planner GINKGO Planning & Design
Tourism & Hospitality HVS
Civil and Stormwater Management Spaceco
Planning & Implementation NCICG
Transportation KLOA
Landscape Architecture Hitchcock Design Group



2013 COMPREHENSIVE PLAN AND DOWNTOWN PLAN UPDATE
CITY OF OTTAWA, IL

SECOND PUBLIC FORUM SEPTEMBER 16, 2013

AGENDA

WHAT WE HEARD :
SUMMARY OF COMMUNITY FEEDBACK

SHOWCASING POSSIBILITIES:
INITIAL IDEAS AND SKETCHES

BREAK TO LOOK AT VISUALS

FEEDBACK AND NEXT STEPS



2013 COMPREHENSIVE PLAN AND DOWNTOWN PLAN UPDATE

CITY OF OTTAWA, IL

THIS PROJECT WILL LOOK AT OTTAWA AT THREE SCALES



THE REGION

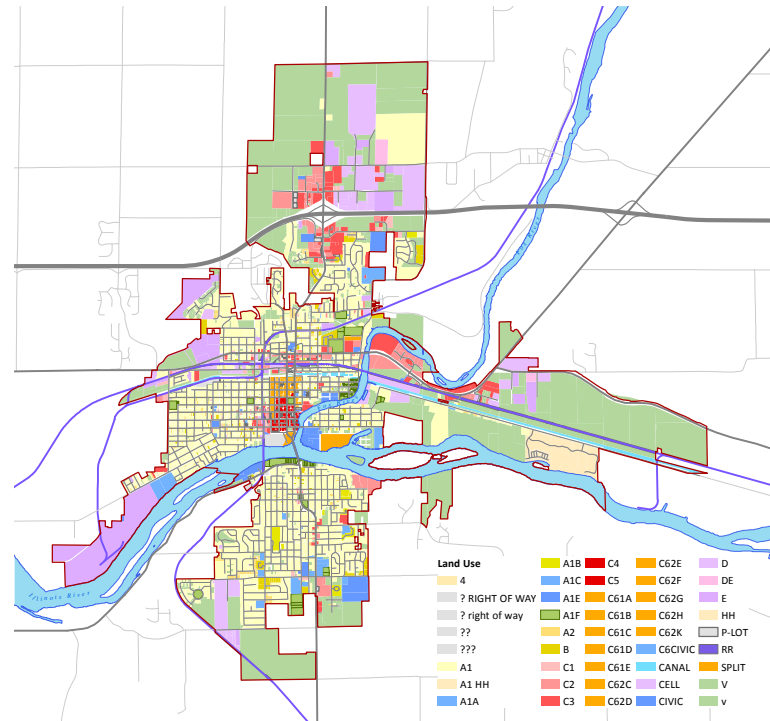

THE CITY



THE WATERFRONT SITES

PLANNED COMPLETION: SPRING 2014

ORGANIZING THE POSSIBILITIES



**MAJOR
ANCHORS**

**DETAILS
& SUPPORT
FACILITIES**

**EVENTS
& PROGRAMS**

ORGANIZING THE POSSIBILITIES

- A CONTINUOUS PUBLIC RIVERWALK
- AMPHITHEATER / BANDSTAND
- ICE SKATING RINK
- ARBORETUM / BOTANIC GARDEN
- WATERFRONT FACILITIES
 - BOAT DOCKS, MARINA, FERRY / RIVER CRUISE TERMINAL



**MAJOR
ANCHORS**

ORGANIZING THE POSSIBILITIES

- **COMMUNITY AND CIVIC ANCHOR**

- LIBRARY
- ART GALLERY / ART MUSEUM / ARTISTS STUDIOS
- COMMUNITY RECREATION FACILITY / GYM / FITNESS CENTER / INDOOR AND OUTDOOR POOL
- PERFORMING ARTS CENTER / THEATER / AUDITORIUM
- OTTAWA VISITORS CENTER / A NEW OTTAWA MUSEUM / KIDS SCIENCE CENTER / RIVER THEMED MUSEUM / OTTAWA WATERWAY MUSEUM / BOAT BUILDING CLUB

- **INDOOR GATHERING FACILITY**

- MEETING HALL, MULTI PURPOSE HALL, WEDDING/BANQUET HALL
- CONVENTION CENTER

- **ACTIVE RECREATION**

- INDOOR/OUTDOOR ICE FACILITY, INDOOR HOCKEY
- VOLLEYBALL, SAND VOLLEYBALL, SKATEBOARDING PARK, BASKETBALL
- KAYAKING, CANOEING, PADDLE BOATING, WHITEWATER RAFTING
- ZIPLINING, WINTER TOBOGGANING & SLEDDING, BMX BICYCLE PARK



**MAJOR
ANCHORS**

ORGANIZING THE POSSIBILITIES

• LODGING

- HOTELS
- RIVERBOAT HOTEL
- BED AND BREAKFASTS, INNS
- UPPER LEVEL REUSE OF DOWNTOWN BUILDINGS
- COTTAGES

• FOOD

- RESTAURANTS AND BARS, WATERFRONT RESTAURANTS, FLOATING RESTAURANTS
- PORTABLE FOOD VENDORS , FOOD TRUCKS / TRAILERS
- FARMERS MARKET

• OTHER COMMERCIAL DEVELOPMENT

SMALL RIVERBOAT CASINO

TOURIST SHOP

BAIT SHOP

BIKE RENTAL, BOAT CANOE RENTAL, GAS STATION FOR BOATS

ANTIQUE STORES, ARTS MARKET, BOTANIC ARTS MARKET

**MAJOR
ANCHORS**

ORGANIZING THE POSSIBILITIES

- PUBLIC RESTROOMS
- PARKING
- PICNIC SHELTERS
- SIGNAGE
- LIMITED FLOWER GARDENS, MORE LOW MAINTENANCE GREEN AREAS
- DOG PARK
- FOUNTAINS/ WATER FEATURES
- TENTS FOR MARKETS
- BLEACHERS, STEPPED SEATING, TERRACES WITH LAWN CHAIRS
- SEATING FOR OUTDOOR CLASSES
- POND FOR MINIATURE BOATS (REMOTE CONTROLLED)
- BOTANICAL DISPLAY
- WATERFALLS, SCULPTURE
- BEACH
- SPLASH PARK
- BIKE TRAILS AND TRAILS FOR ELECTRIC VEHICLES
- FISH CLEANING STATIONS
- PIERS
- LABYRINTH / MAZE
- FLOWER BASKETS ON BRIDGE
- PED BRIDGE AT RAIL BRIDGE
- RENAME ROUTE 71 “THE ROMANTIC ROAD”
- **AND MANY MORE!**

**DETAILS
& SUPPORT
FACILITIES**

ORGANIZING THE POSSIBILITIES

- MUSIC CONCERTS
- FESTIVALS
- FOOD AND WINE FESTIVALS
- BOAT RACES
- GARDEN FESTIVALS
- SCOUT CONFERENCES
- WEDDINGS
- FIREWORKS
- WINTERFEST
- RIVERFEST
- MOREL FEST
- WINTER WONDERLAND
- A DAILY EVENT AT THE SAME TIME EVERY DAY THAT BRINGS ALL TO THE WATERFRONT
- LINCOLN SPEECHES
- AND MANY MORE!

**EVENTS
& PROGRAMS**

WHAT CAN FIT ON THE SITE?

**MAJOR
ANCHORS**

**DETAILS
& SUPPORT
FACILITIES**

**EVENTS
& PROGRAMS**

WHAT CAN FIT ON THE SITE?

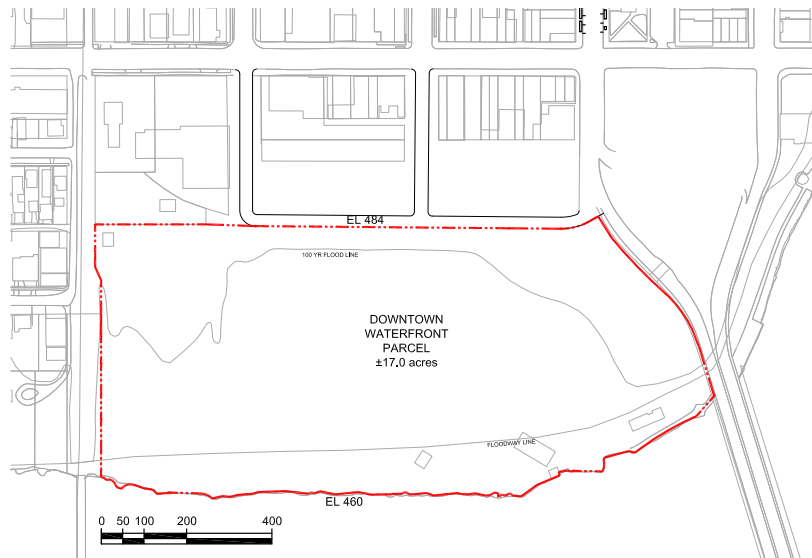

JAY PRITZKER PAVILION



KROC CENTER



AURORA AMPHITHEATRE



HOLLYWOOD BOWL



THE PARK AT ROSEMONT



SPORTSPLEX, ORLAND PARK

AMPHITHEATER AS THE MAJOR ANCHOR



JAY PRITZKER PAVILION



HOLLYWOOD BOWL



AURORA AMPHITHEATRE

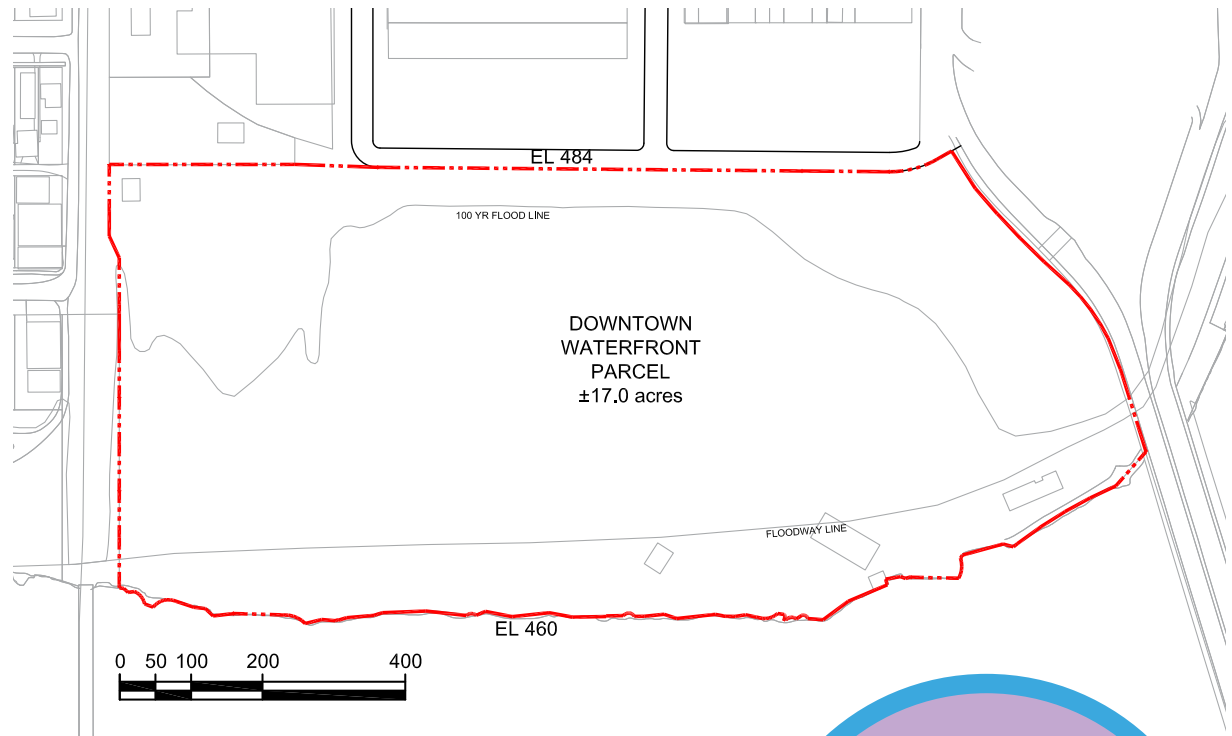

**WHAT
FITS ON
THE SITE?**

AMPHITHEATER AS THE MAJOR ANCHOR

EXAMPLES



Hollywood Bowl, LA

The Hollywood Bowl is a modern amphitheater in the Hollywood area of Los Angeles, California that is used primarily for music performances. It is the largest natural amphitheater in the United States, with a [seating capacity of nearly 18,000](#).

The Hollywood Bowl is known for its band shell, a distinctive set of concentric arches that graced the site from 1929 through 2003, before being replaced with a somewhat larger one beginning in the 2004 season. The shell is set against the backdrop of the Hollywood Hills and the famous Hollywood Sign to the Northeast.

The “bowl” refers to the shape of the concave hillside the amphitheater is carved into. The bowl is owned by the County of Los Angeles and is the home of the Hollywood Bowl Orchestra, the summer home of the LA Philharmonic and the host of hundreds of musical events each year.

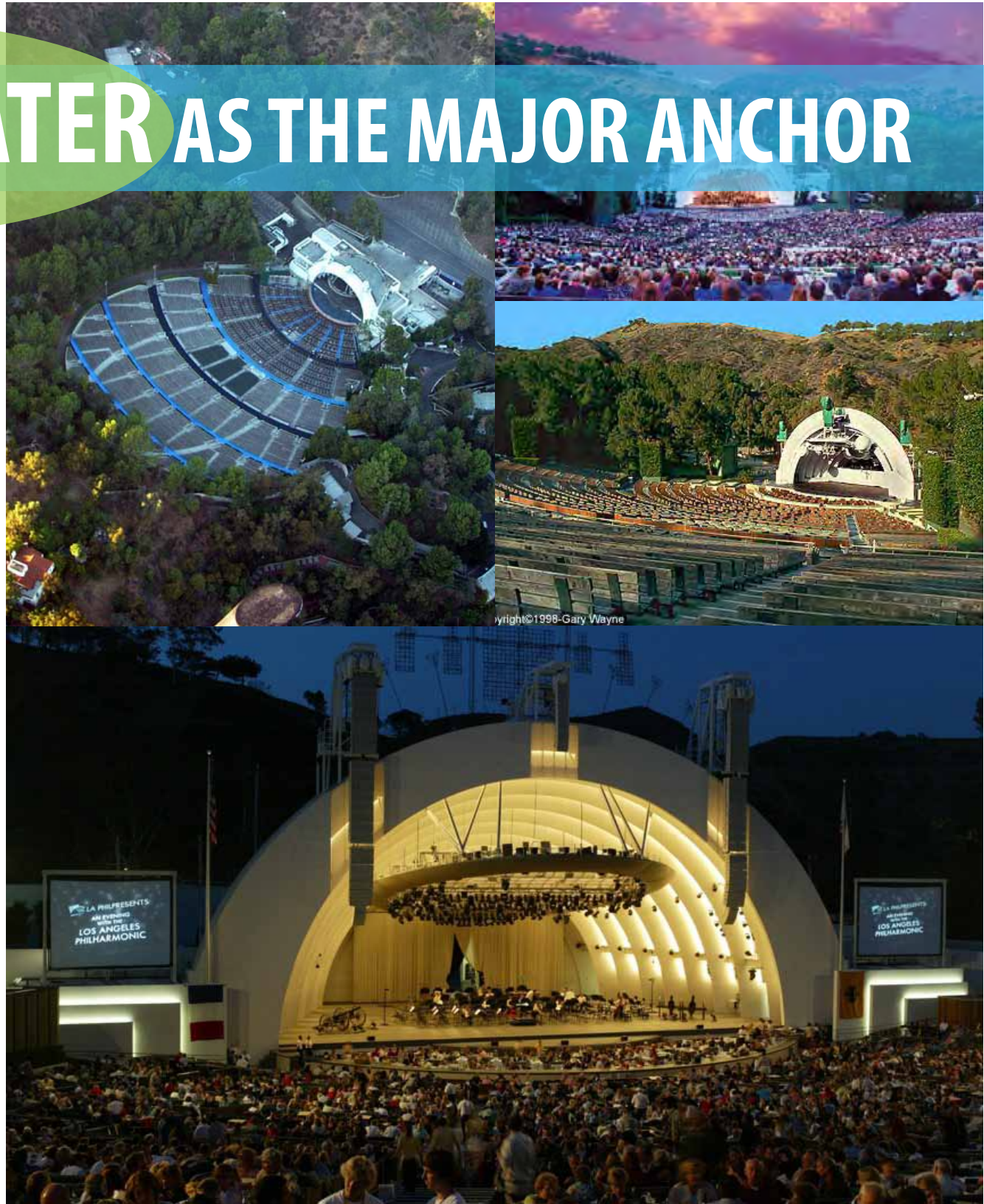

AMPHITHEATER AS THE MAJOR ANCHOR

EXAMPLES



Riverfront Amphitheater, New Albany Indiana

Capacity of 10,000, reopened in 2009 on about 1.5 acre site

The entire project is expected to cost just under \$700,000, about \$100,000 more than the city hoped to pay. Funding sources include insurance money from wind storm damage, the Clark-Floyd Counties Convention & Tourism Bureau, and money from New Albany City Council. The rest of the money for the project is expected to come from fundraising in the area.

The structure is a half-dome of steel and acoustical roofing with the familiar yellow color of the old amphitheater. It reflects the curves of the Sherman-Minton bridge in the background and slightly resembles a rising sun on the Sunny Side. The new canopy will cover 6,000 square feet and the arches would read 100 feet tall.



AMPHITHEATER AS THE MAJOR ANCHOR

Riverfront Amphitheaters in Communities Comparable to Ottawa

Alliant Energy Amphitheater - Dubuque, Iowa



The Alliant Energy Amphitheater adjacent to the Mississippi Riverwalk and near the American Trust River's Edge Plaza. The Amphitheater faces the restored Star Brewery and is used for special events, festivals and concerts. Rental fees are \$200 per day for private events. Dubuque's population is approximately 58,000.

Vetter Stone Amphitheater -- Mankato Minnesota



The Vetter Stone Amphitheater is part of the Riverfront Park in Old Town Mankato, Minnesota. Riverfront Park is a 14-acre park that provides riverfront recreation amenities and access to Mankato residents and visitors. With a population of approximately 40,000, Mankato is comparable in size to Ottawa. Some of the Riverfront Park's features include: a playground and fun play equipment for children, educational kiosks, an exhibit featuring poems written by citizens, and access to the river for recreational boating, canoeing, kayaking and fishing. The amphitheater was recently constructed for approximately \$2 million.

Riverloop Amphitheater - Waterloo Iowa



The Riverloop Amphitheater opened in the summer of 2012 and is the last project of Waterloo's River Renaissance Projects. Constructed as a part of the flood wall along the Mississippi River, it has become an important landmark in Waterloo. It has 600 tiered seats and a permanent stage. The amphitheater is adjacent to an arts mall and Mark's Splash Park. Operated by the Waterloo Center for the arts, the venue is booked for weddings, concerts and other public and private events. Waterloo has a population of approximately 68,000.

Alton Amphitheater -- Alton, Illinois



Alton's 4,500 seat Amphitheatre is located near the Argosy Casino and the Alton Marina and is the centerpiece of the ambitious renewal of the Alton riverfront vicinity of this historic town on the Mississippi River. A five dollar Fridays summer concert series features tribute bands. The venue is also available for rentals. Alton has a population 28,000 is 15 miles north of St. Louis.

COMMUNITY CENTER AS A MAJOR ANCHOR

EXAMPLES

The \$70 million, 215,000-square-foot center provides much needed fitness and aquatic facilities for the campus community. The three-floor CRWC, located at the southwest corner of Burlington and Madison streets, features a 52.5-foot climbing wall, competition pool with spectator seating for up to 2,000, high dive pool, two full-size basketball courts and multi-activity court, 1/9-mile indoor track, leisure pool with a “lazy river” feature and a giant video board for movie screenings, three activity rooms, and much more.

The fitness area in the new building spans more than 20,000 square feet over three floors, with machines featuring embedded televisions and iPod hook-ups and floor-to-ceiling windows overlooking Burlington Street and Gibson Square.

While the center was designed as a student recreation facility, it offers much more. It will serve as the new home of the men’s and women’s varsity athletic swimming and diving teams competitive swimming and diving pool, as well as offices for Recreational Services, UI Wellness and Health Iowa.

The CRWC also has steam and sauna rooms, locker rooms, lounge areas and a café featuring smoothies and other light refreshments. Parking is available one block southeast.



UNIVERSITY OF IOWA RECREATION CENTER



COMMUNITY CENTER AS A MAJOR ANCHOR

RAY AND JOAN KROC CENTER, CHICAGO, IL

The 160,000-square-foot Kroc Center sits on a 33 acre campus and offers a wide array of activities and services for people of all ages.

Joan Kroc, wife of McDonald's founder Ray Kroc, had a clear vision: build state-of-the-art facilities in underserved communities throughout the nation with the highest quality recreational and arts facilities to ensure that all children have equal opportunities to build their natural gifts and talents. In 2003, Mrs. Kroc passed away, and entrusted to The Salvation Army the largest gift ever given to a private charity for the express purpose of building and endowing Kroc Centers.

A fulfillment of that vision, the Kroc Center in Chicago is a state-of-the-art community and social service facility set on 33 acres on the South Side of Chicago.



ICE RINK AND STAGE AS A MAJOR ANCHOR

EXAMPLES

Falls River Square, Cuyahoga Falls, Ohio

The Falls River Square Festival and Special Event Site was created for the residents of Cuyahoga Falls, however, it is enjoyed by the entire northeast Ohio region. The perfect destination location for fine or casual dining, attending a special event, or taking a stroll along the riverfront boardwalk, the Falls River Square district has something for everyone!

The Pavilion, Stage, Amphitheatre and Interactive Water Fountain are magnificent additions to the downtown riverfront district accommodating a variety of functions from wedding ceremony and receptions to concerts and celebrations.

The Pavilion features 3,500 square feet of spectacular meeting and banquet space complete with breathtaking views of the Cuyahoga River from the outdoor walkways on the Plaza and Upper Level. A beautifully tiled gas fireplace and hearth complete the space along with kitchenette, 40 public restrooms and an elevator.

This beautiful indoor Pavilion is open year-round and available for lease for any special event. It is conveniently located at the corner of Broad Blvd. and Front St. at the Clock Tower. Also available is the amphitheatre and stage area. Offering a 40' x 60' stage, 290 stadium-style seats, and a PA System with microphone - this is the ideal location for local entertainers, kick-off events and special ceremonies.



ICE RINK AND STAGE AS A MAJOR ANCHOR

EXAMPLES

Washington Harbor

Georgetown, Washington DC

At 11,800 square feet, the new Washington Harbour Ice Rink is DC's largest outdoor ice skating venue, and is also larger than New York City's Rockefeller Center rink. The Washington Harbour Ice Rink officially opens for the public skating season in mid-November after a transformation from its interchangeable use as a [picturesque fountain](#). The Washington Harbour Ice Rink will be open annually from November until March for recreational skating every day, including all holidays.

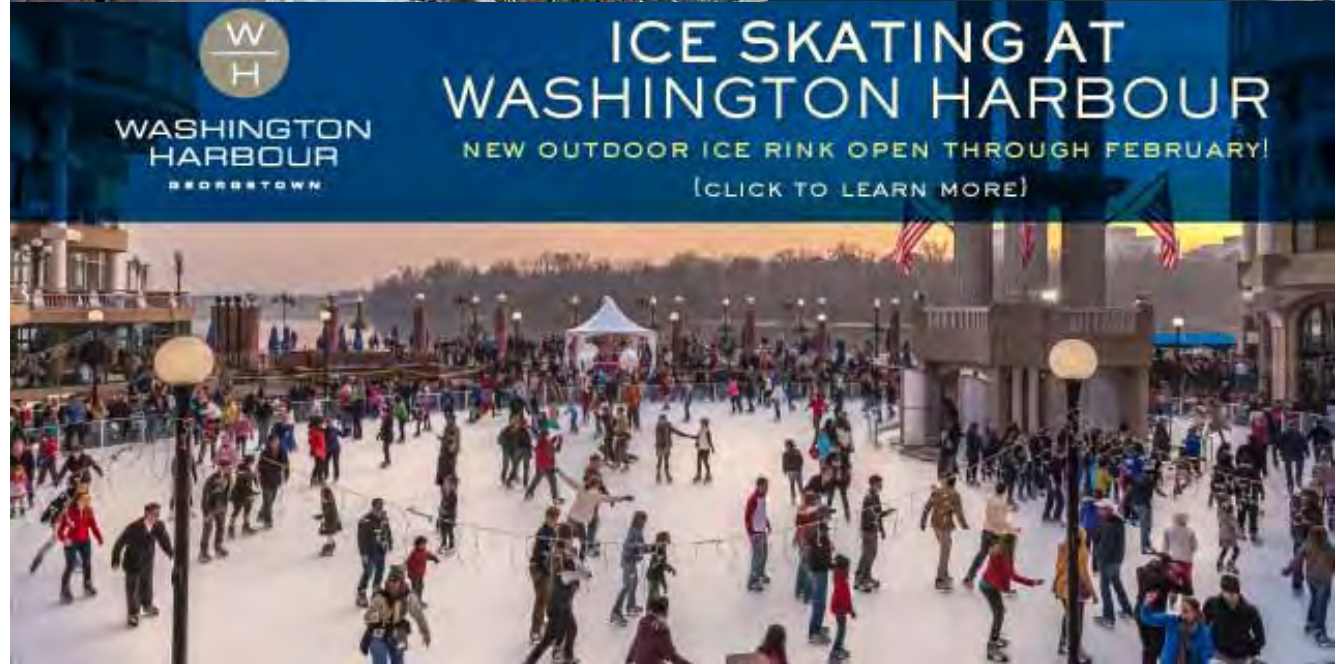
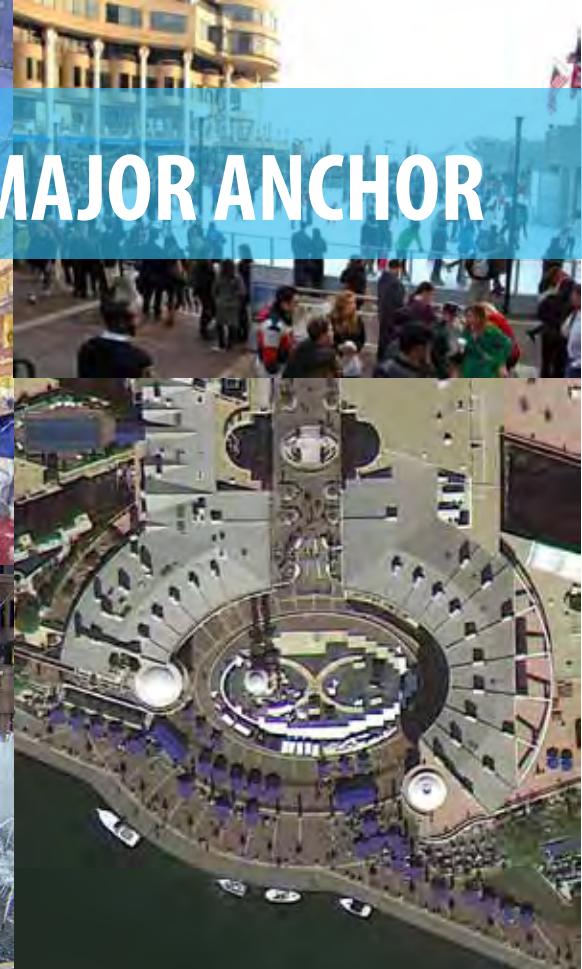

ICE RINK AND STAGE AS A MAJOR ANCHOR

THE PARK AT ROSEMONT, ROSEMONT, IL

MB Financial Park at Rosemont is a 200,000 square-foot entertainment and dining complex that, when complete, will house eight venues offering upscale international cuisine, live music and comedy, state-of-the-art film, bowling and more. Joining the popular upscale cinema Muvico, Five Roses Pub opened in April 2012 and Kings Lanes, Lounge & Sports

Other venues include Adobe Gila's, Toby Keith's I Love This Bar & Grill, Zanies Comedy Night Club, Park Tavern, Hofbräuhaus Chicago and a yet-to-be named Greek restaurant.

Located at 5501 Park Place, the centerpiece of MB Financial Park at Rosemont is a beautifully landscaped area featuring a great lawn for festivals and sporting events as well as an ice-skating rink in colder months.



EXAMPLES

WATER RECREATION AS A MAJOR ANCHOR

CONFLUENCE PARK, DENVER

EXAMPLES



WATER RECREATION AS A MAJOR ANCHOR

EXAMPLES

Confluence Park is an urban park encompassing the confluence of Cherry Creek and the South Platte River in Denver's Lower Downtown (LoDo), a bustling district of 19th-century brick warehouses and storefronts that has been redeveloped since the late 1980s.

The park includes concrete trails often filled with walkers, runners, and bikers. Some grassy areas, river overlooks, and park benches are also available. Two pedestrian bridges cross the South Platte River and Cherry Creek at Confluence Park. The eastern edge of the South Platte in Confluence Park has been transformed into a kayak run, immediately across from R.E.I.'s (Recreational Equipment Inc.) Colorado flagship store. The park is adjacent to a number of new up-scale townhouses, apartments, and loft developments, another park bordering the South Platte downstream, train tracks, and Denver's skatepark.

On warm Tuesday and Friday nights, fire performers and drummers practice fire spinning to the sounds of a drum circle by the water.

Confluence park marks the area where gold was discovered in 1858 by William Greeneberry Russell. This gold discovery led to the founding of Denver. Part of the site was previously an Xcel Energy substation that was relocated to allow for the expansion of the park.



WATER RECREATION AS A MAJOR ANCHOR

Riverfront Park

Charles City, Iowa

Since 2011, the Cedar River, which runs through Riverfront Park, has become a mecca for tubers, paddlers, fishermen and others simply wanting to take advantage of the only white-water paddling course and park in Iowa. [The Riverfront Park has three kayaking courses and also has become a popular spot for tubing, fishing or simply relaxing during Iowa's hot summer months.](#)

Planning for the new park began in 2006 as community leaders began to ask how they could develop the river into a better resource not only for recreational purposes, but also to help attract new economic development.

After reviewing the idea with landscape architects, the idea of [lowering the city's potentially dangerous low-flow dam to allow for kayaking and tubing gained momentum.](#) One reason was that high wall concrete levies – typically found along rivers in Iowa urban areas – had not been built in downtown Charles City.

Plans for the park stalled in 2008, when heavy rains inundated the Cedar River Watershed and created record-level floods in many cities along the 200-mile river. In downtown Charles City, the Cedar crested to more than 25 feet, causing



millions of dollars in damage and destroying the 102-year-old landmark suspension bridge just north of downtown.

Undeterred by the flooding and its clean-up cost, city officials revived the plans for the park and raised more than \$350,000 locally to match an additional \$1.3 million from state sources. Construction, which included hauling in 10,200 tons of limestone and 40 red granite boulders, began in 2010. In July, the river flows at an average rate of about 500 cubic feet per second (cfps) – though this summer that rate has dropped to a meandering 200 cfps because of drought conditions. But those flows can change quickly if heavy rains hit northern Iowa and southern Minnesota.

The three paddling features aren't the only attraction to the Charles City Riverfront Park. The surrounding 23 acres of park land feature a disc golf course, natural play areas, an amphitheatre, storm water foundation, labyrinth and access to more than five miles of recreational trails.

EXAMPLES



BRING THE WATER IN AS A MAJOR ANCHOR

EXAMPLES

ISLANDS AND PIERS

PIER C PARK

Hoboken, NJ

Pier C Park is located along the Hudson River Waterfront Walkway in Hoboken, New Jersey and is part of the city's ongoing efforts to provide recreational open space at the water's edge. An active recreation pier designed to accommodate users of all ages, the new park complements neighboring parks in program and form. Pier C represents a new generation of waterfront programming, defined by recreation and public access rather than industrial or maritime uses. The new pier sits within the rectilinear footprint of the long-absent original Pier C, with arcing walkways that capitalize on views of Manhattan as well as the active uses of the pier.

The sculptural quality of the landscape simulates the forms of a barrier beach while the interior breaks open to reveal the play landscape—a whimsical, other-scaled world designed to engage children of all ages and abilities. The playground is separated into a pre-school play area and a school-age play area including structures for climbing and hiding, slides, sand play, water play, climbable slopes, rockers and spinners. A continuous tricycle path loops through the interior of the play area and a park building is situated such that an employee can easily dispense toys to children.

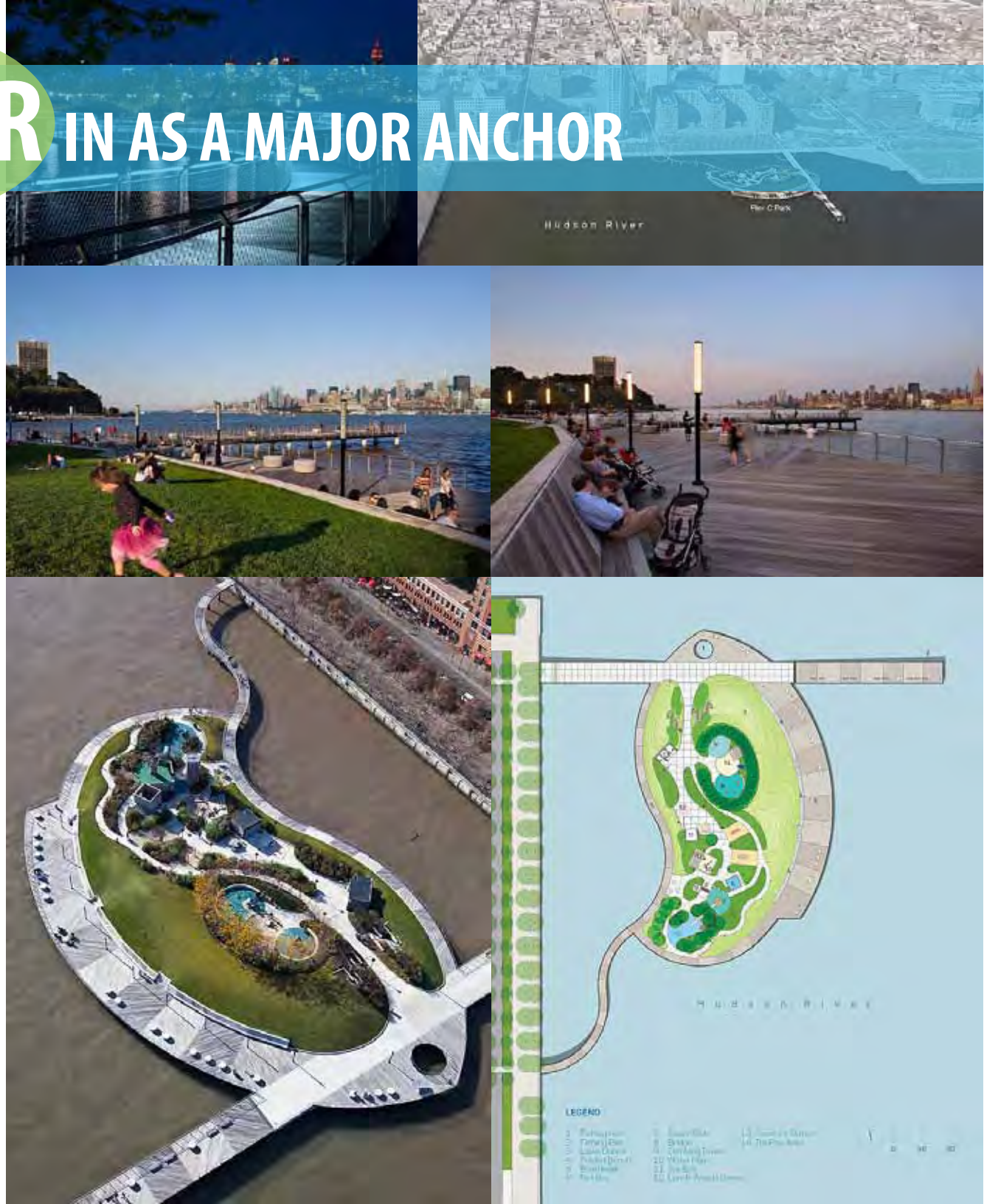

BRING THE WATER IN AS A MAJOR ANCHOR

EXAMPLES

NATURAL ISLANDS

Red Ribbon Park, China

Qinhuangdao, China A “red ribbon” was designed against the background of green vegetation and blue water. This ribbon stretches for 500 meters along the riverbank, integrating a boardwalk, lighting, seating, environmental interpretation, and environmental orientation. It is made of fiber steel, and lit from inside so that it glows red at night. It stands 60 cm high, and its width varies from 30-150 cm. Various plant specimens are grown in strategically placed holes in the ribbon.

Embankments and canals are replaced by parks which provide space for water. Marsh plants such as lotus, reeds and rice provide natural and flexible reinforcement for the shoreline. For the giant dimensions of the Turenscape Landscape Architects projects these ‘natural’ solutions represent a method of revitalising large, desolate areas within a short space of time.

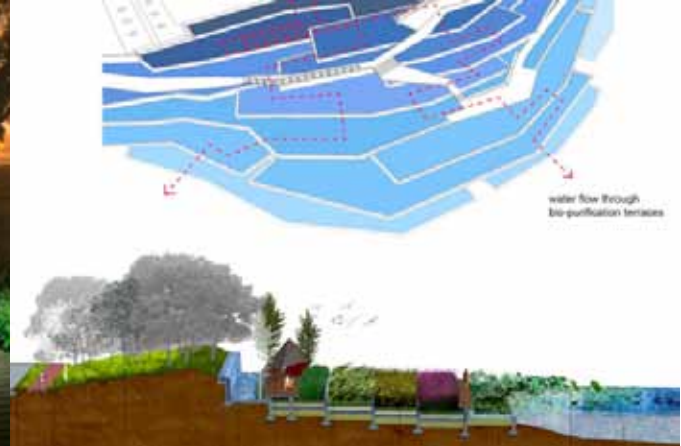

BRING THE WATER IN AS A MAJOR ANCHOR

ISLANDS

Northerly Island, Chicago

The Chicago Park District and the City of Chicago have been working on the Northerly Island Park, a 91-acre man-made peninsula in Chicago, Illinois. The design transforms Northerly Island into an ecologically diverse park. The island will be unique compared to Chicago's other lakefront environments with the addition of lagoons, seasonal ponds, fishing coves, and many other water-scapes. Without even leaving the city, visitors can retreat to the island to swim in the lake, camp in the forest, view art installations, and hike on its miles of paths.

Northerly Island Park's barrier reef will create a soft, green lakefront edge. Kayaking, snorkeling, and diving are all future activities and programs of the site. The reef system is not only recreational but will also be an investment in the health of Lake Michigan's ecosystems.

This ecological addition includes 12 acres of fish spawning habitat, 40 acres of migratory bird habitat, and 19 acres of wetland. A music amphitheater, retail and concessions along the Harbor Walk, along with an Education Center and Event Pavilion on the Great Lawn, are all venues that help make the park economically practical. The amphitheater will be able to seat 12,000 to 14,000 fans for concerts and events, but will also serve many other functions. For example, it will incorporate star-gazing structures as an expansion of Adler Planetarium. In the wintertime, the theater can be used as a large ice skating rink.

EXAMPLES



BRING THE WATER IN AS A MAJOR ANCHOR

NORTH POINT MARINA

North Point Marina is a World Class Marina at a World Class Value to you: convenient on-site amenities such as boat maintenance and repair, fuel, dry winter storage, transient slips, Great Room, beaches, ship's store and restaurant .

One of the largest marinas on the Great Lakes sports a protected floating dock system of 1,500 slips, from 30 to 60 feet. Our signature "One Price" slip rental includes electricity, water, TV hookup, Free WiFi, sanitary pump-outs, dock lockers, showers and restrooms, restricted parking and 24-hour security .

North Point Marina is located in Winthrop Harbor, Illinois, on Lake Michigan midway between Chicago and Milwaukee.



EXAMPLES



A DAILY EVENT AS A MAJOR ANCHOR

EXAMPLES

WATERFIRE PROVIDENCE



source: <http://waterfire.org/> . video at <http://vimeo.com/14090749>

A DAILY EVENT AS A MAJOR ANCHOR

EXAMPLES

WATERFIRE PROVIDENCE



WaterFire Providence® is an independent, non-profit arts organization whose mission is to inspire Providence and its visitors by revitalizing the urban experience, fostering community engagement and creatively transforming the city by presenting WaterFire for all to enjoy.

This award-winning sculpture by Barnaby Evans installed on the three rivers of downtown Providence, has been praised by Rhode Island residents and international visitors alike as a powerful work of art and a moving symbol of Providence's renaissance. WaterFire's over eighty sparkling bonfires, the fragrant scent of aromatic wood smoke, the flickering firelight on the arched bridges, the silhouettes of the firetenders passing by the flames, the torch-lit vessels traveling down the river, and the enchanting music from around the world engage all the senses and emotions of those who stroll the paths of Waterplace Park. WaterFire has captured the imagination of over ten million visitors, bringing life to downtown, and revitalizing Rhode Island's capital city.

Cited by the [Providence Journal] in 1997 as "the most popular work of art created in the capital city's 371-year history" and by Friedrich St. Florian as the "crown jewel of the Providence renaissance," WaterFire continues to grow and gain in popularity. Barnaby Evans created First Fire in 1994 as a commission to celebrate the tenth anniversary of First Night Providence. In June 1996, Evans created Second Fire for the International Sculpture Conference where it became the gathering place for thousands of participants from all over the world. Ardent art supporters convinced Evans to create an on-going fire installation and started a grass-roots effort to establish WaterFire as a non-profit arts organization. With the support of hundreds of dedicated [volunteers](#), a hard working staff, generous [donations](#) from visitors, contributions from corporate leaders, and support from the City and State, WaterFire's bright flames now regularly return to illuminate downtown Providence.



In 1997, WaterFire Providence expanded to 42 braziers, and attracted an estimated attendance of 350,000 people during thirteen lightings. Evans received the Renaissance Award from the City of Providence for his work as an artist and his role in revitalizing downtown Providence.

In response to growing attendance, WaterFire expanded in size to 81 braziers in 1998; and 97 braziers in 1999. The 1999 season culminated with 100 bonfires in a special WaterFire lighting for the December 31 millennium celebrations. With WaterFire's 2000 season more than thirty sponsors helped host 25 lightings during a season that ran from March to October. WaterFire celebrated its 200th lighting in August, 2006.

Hundreds of volunteers devote thousands of hours and join with the fulltime staff to create WaterFire for your enjoyment. The power of WaterFire Providence to attract millions of visitors is eloquent testimony to the importance of public art and its capacity to restore our urban and social landscape.



WHAT ARE THE DESIGN PRINCIPLES TO ORGANIZE THESE ON THE SITE?

**MAJOR
ANCHORS**

**DETAILS
& SUPPORT
FACILITIES**

**EVENTS
& PROGRAMS**

A MASTER PLAN IS A FRAMEWORK TO GUIDE DEVELOPMENT

**A LONG TERM
FRAMEWORK
THAT ALLOWS
A LARGE
PROJECT
TO MOVE
FORWARD IN
MEANINGFUL
PHASES.**



A MASTER PLAN IS A FRAMEWORK TO GUIDE DEVELOPMENT

**A LONG TERM
FRAMEWORK
THAT ALLOWS
A LARGE
PROJECT
TO MOVE
FORWARD IN
MEANINGFUL
PHASES.**



**A LONG TERM
FRAMEWORK
THAT ALLOWS
A LARGE
PROJECT
TO MOVE
FORWARD IN
MEANINGFUL
PHASES.**



PRIVATE DEVELOPMENT AND FRONT DOORS FACING THE PARK



CREATE A CONTINUOUS PUBLIC RIVERWALK

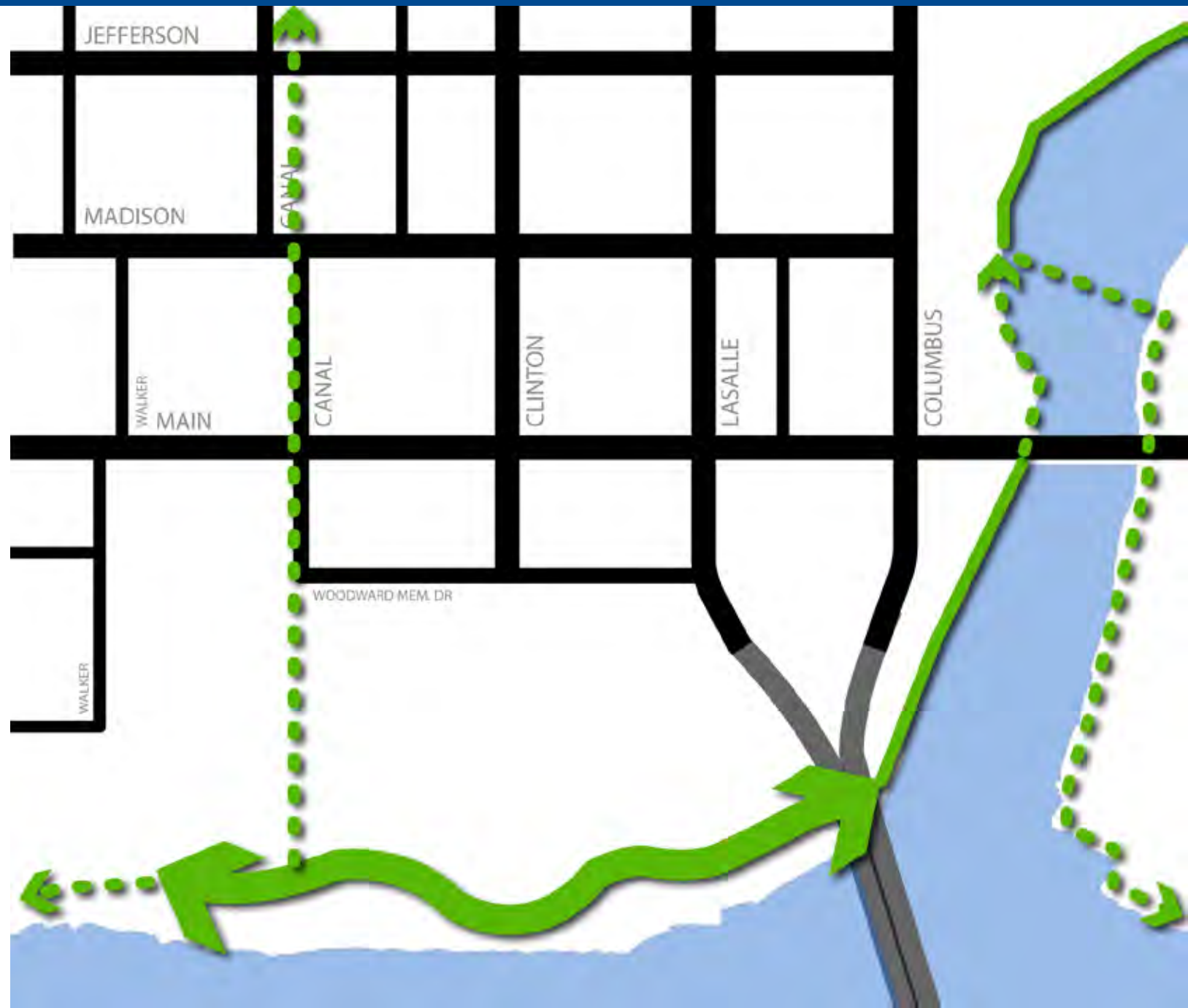

CONNECT DOWNTOWN TO THE WATERFRONT



AMPHITHEATER AS VIEW TERMINUS OF LASALLE ST.

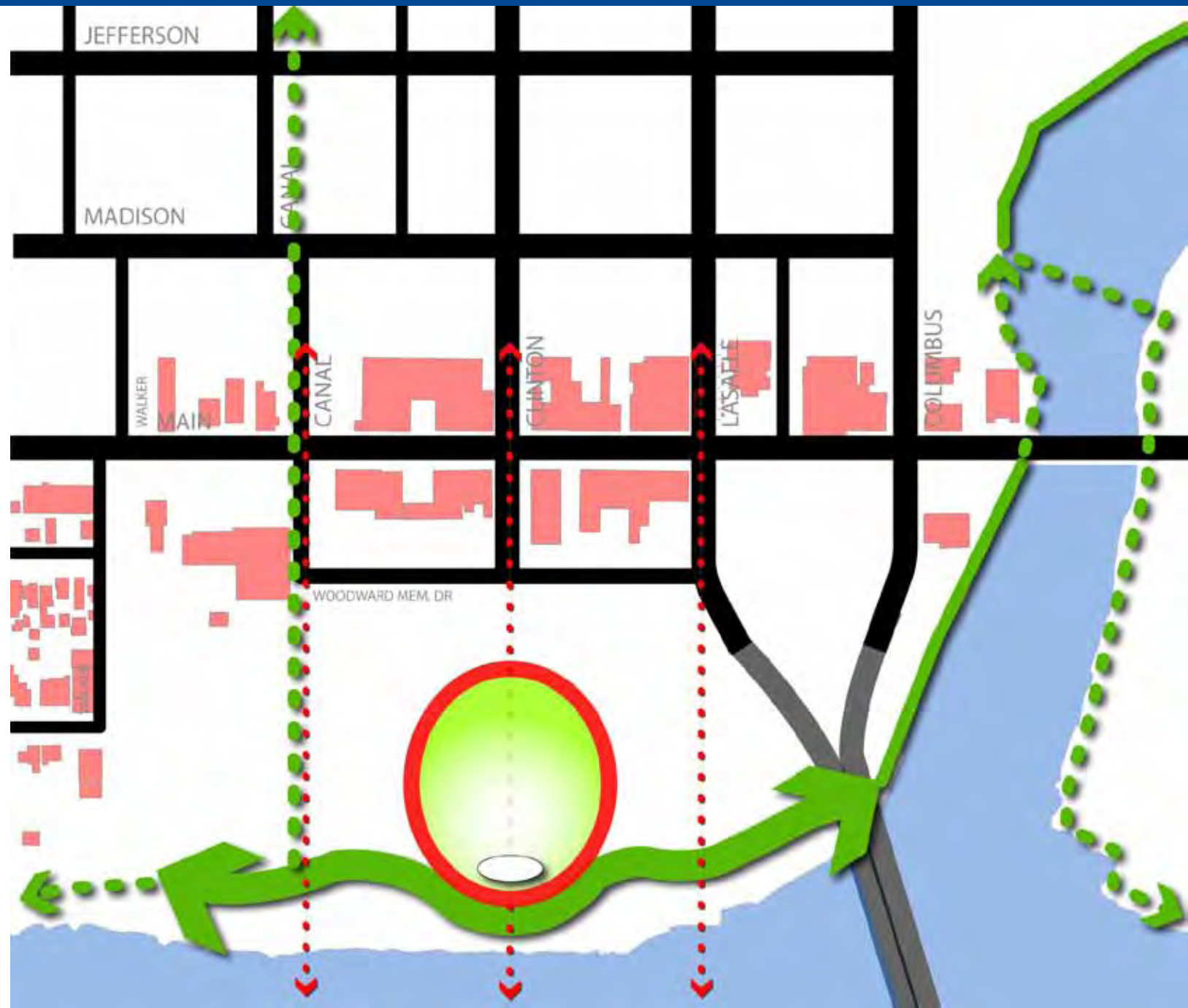

AMPHITHEATER AT SCHOOL TRACK LOCATION



AMPHITHEATER AS VIEW TERMINUS OF LASALLE ST. AND FACING JORDAN BLOCK



AMPHITHEATER AS VIEW TERMINUS OF LASALLE ST. AND FACING JORDAN BLOCK



THE SITE IS BEHIND MAIN STREET BUILDINGS

**THERE ARE NO
BUILDINGS
FACING THE
SITE TODAY**



CREATE DEEPER BLOCKS FOR NEW BUILDINGS TO FACE THE PARK

**THERE ARE NO
BUILDINGS
FACING THE
SITE TODAY**



SHOWCASING POSSIBILITIES



TWO INITIAL CONCEPTS FROM POSSIBILITIES



CREATE CLEAR AND VIABLE DEVELOPMENT PARCELS



DOWNTOWN WATERFRONT WITH RETAIL RESTAURANTS AND AMPHETHEATRE



DOWNTOWN WATERFRONT SITE AT FULL BUILDOUT



CREATE CLEAR AND VIABLE DEVELOPMENT PARCELS



DOWNTOWN WATERFRONT WITH RETAIL RESTAURANTS AND AMPHETHEATRE



DOWNTOWN WATERFRONT SITE AT FULL BUILDOUT



CREATE CLEAR AND VIABLE DEVELOPMENT PARCELS

UNDERSTAND

WHAT IS
PUBLIC,

WHAT IS
PRIVATE,

AND WHAT IS
**A PUBLIC/
PRIVATE
PARTNERSHIP**

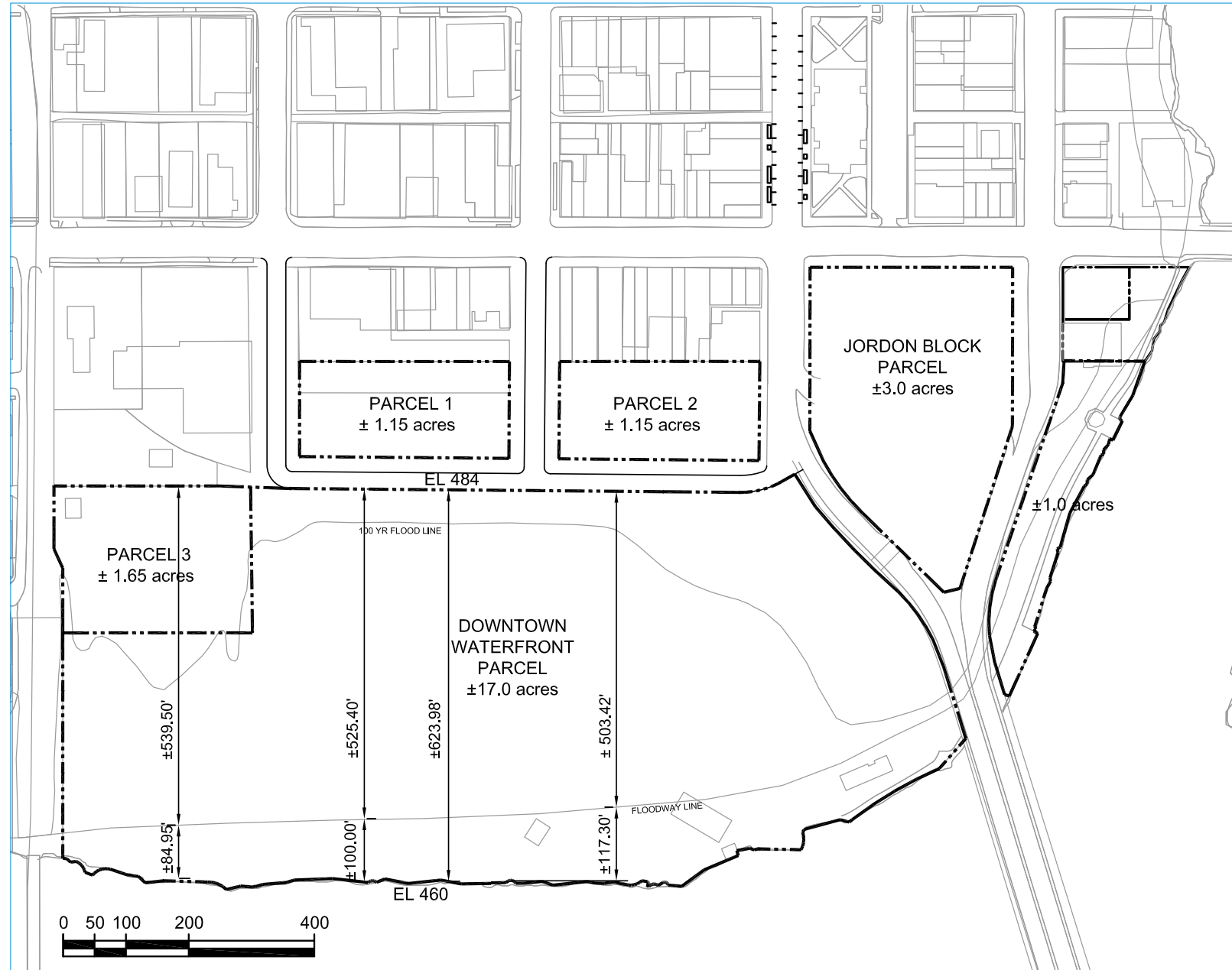

BIG PRINCIPLES FOR THE MASTER PLAN

THIS IS NOT JUST A PARK. THIS IS NOT JUST ABOUT THE FORMER CENTRAL SCHOOL SITE OR JORDAN BLOCK. THIS IS OTTAWA'S DOWNTOWN WATERFRONT.

- 1. Connect and Extend DOWNTOWN to the waterfront.**
- 2. Create a continuous PUBLIC RIVERWALK** along the river edge and connect to the existing riverwalk to the east. Plan for future connections to the I & M trail through Canal Street and east to Heritage Harbor.
- 3. Create a DEVELOPMENT FRAMEWORK** to build the MEGABLOCK in small viable phases for both PRIVATE and PUBLIC investment.

2013 COMPREHENSIVE PLAN AND DOWNTOWN PLAN UPDATE
CITY OF OTTAWA, IL

SECOND PUBLIC FORUM SEPTEMBER 16, 2013

AGENDA

WHAT WE HEARD :
SUMMARY OF COMMUNITY FEEDBACK

SHOWCASING POSSIBILITIES:
INITIAL IDEAS AND SKETCHES

BREAK TO LOOK AT VISUALS

FEEDBACK AND NEXT STEPS



DOWNTOWN WATERFRONT SITE AT FULL BUILDOUT



2013 COMPREHENSIVE PLAN AND DOWNTOWN PLAN UPDATE

CITY OF OTTAWA, IL

SECOND PUBLIC FORUM SEPTEMBER 16, 2013

NEXT STEPS

**NEXT PUBLIC FORUM:
NOVEMBER 2013, DATE TO BE
DETERMINED**

**1 GOALS OF THE 2013
COMPREHENSIVE PLAN**

2 DOWNTOWN SUB AREA PLAN

**3 UPDATE ON WATERFRONT
MASTER PLAN**

