

2013 COMPREHENSIVE PLAN AND DOWNTOWN PLAN UPDATE
CITY OF OTTAWA, IL

THIRD PUBLIC FORUM DECEMBER 4, 2013

Prime Consultant and Lead Planner GINKGO Planning & Design
Tourism & Hospitality HVS
Civil and Stormwater Management Spaceco
Planning & Implementation NCICG
Transportation KLOA
Landscape Architecture Hitchcock Design Group



2013 COMPREHENSIVE PLAN AND DOWNTOWN PLAN UPDATE

CITY OF OTTAWA, IL

PLANS FOR OTTAWA AT THREE SCALES



THE REGION

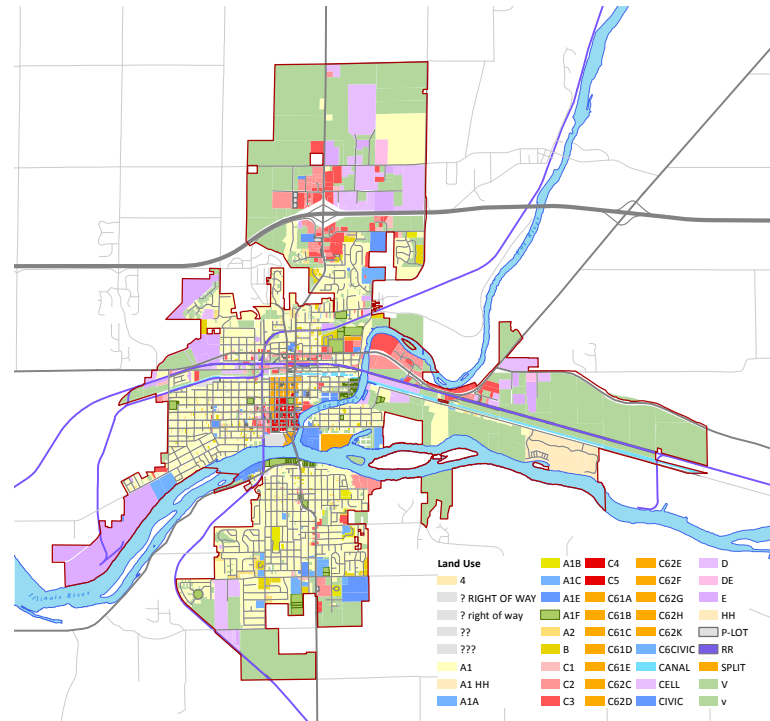

THE CITY



DOWNTOWN & WATERFRONT

PLANNED COMPLETION: SPRING 2014

2013 COMPREHENSIVE PLAN AND DOWNTOWN PLAN UPDATE

CITY OF OTTAWA, IL

THIRD PUBLIC FORUM DECEMBER 4, 2013

AGENDA

**WATERFRONT AND
BOARDWALK**

**DOWNTOWN
MASTER PLAN**

**MARQUETTE
DISTRICT**



Welcome to the
City of Ottawa, Illinois



[Home](#) [Residents](#) [Visitors](#) [Businesses](#) [Government](#)

CITY SERVICES

- Applications, Forms & Permits
- ADA Compliance
- Boards & Commissions
- Boards & Commissions Agendas & Minutes
- Census
- Character Counts
- City Council
- City Council Agendas, Minutes & Videos
- City Directory
- Combined Sewer Overflows (CSO)
- Community Development
- Economic Development
- Electric Aggregation
- Education
- Finance
- Fire/Police Department
- LaSalle County
- Legislature
- Maps
- Mini Bus/Taxi/Parking
- Municipal Codes
- Parks
- Recreation
- Reddick Library
- Streets
- Transportation
- Utilities
- Water
- Waste Water

Welcome to the City of Ottawa, Illinois!

Visitors to Ottawa soon discover why it was one of the first great cities to sprout from the Illinois Prairie. Located in a beautiful valley at the confluence of the Fox and Illinois Rivers ... [read more](#)



Mayor Robert M. Eschbach

LATEST NEWS

Ottawa Community Garden

Ottawa Comprehensive Plan & Downtown Plan Update

First and Second Public Forum

Comments & Presentations



[Hydrant Flushing 2013](#)

[Leaf Vac Schedule 2013](#)

2013 SANTA'S HOURS

SANTA'S VISITING HOURS



WHAT WE HEARD FROM YOU

FIRST FORUM JULY

SECOND FORUM SEPTEMBER

GREAT POSITIVE RESPONSE OF BOLD IDEAS

SUMMARY LIST OF COMMUNITY IDEAS FOR THE DOWNTOWN WATERFRONT SITES

MAJOR PUBLIC ANCHORS

- AMPHITHEATER / BANDSTAND
- MONOLITHIC BANDSHELL
- INDOOR/OUTDOOR ICE FACILITY / SKATING RINK
- LIBRARY
- ART GALLERY / MUSEUM / ARTISTS STUDIOS
- INDOOR / OUTDOOR POOL
- GYM / FITNESS CENTER
- COMMUNITY RECREATION FACILITY
- PERFORMING ARTS CENTER
- ARBORETUM / BOTANIC GARDEN
- GREENHOUSE AND GIFT SHOP, PERHAPS GARDEN RELATED MERCHANDISING
- PLACE FOR ARTISTS TO SELL WORK
- CONVENTION CENTER
- MEETING HALL, MULTI PURPOSE HALL FOR EVENTS
- SCENIC VENUE FOR WEDDINGS, BANQUET HALL
- FARMERS MARKET / BOTANIC ARTS MARKET
- BOTANICAL GARDEN / RIVER THEMED MUSEUM
- KIDS SCIENCE CENTER
- OTTAWA VISITORS CENTER / A NEW OTTAWA MUSEUM
- BANQUET HALL
- THEATER
- AUDITORIUM
- INDOOR HOCKEY
- BOAT BUILDING CLUB FOR YOUTH
- BOAT DOCKS
- MARINA
- FERRY TERMINAL / RIVER CRUISES
- PUBLIC RESTROOMS

LANDSCAPE ELEMENTS

- PUBLIC RIVERWALK
- SHALLOW POOL FOR SUMMER, ICE RINK IN WINTER
- PICNIC SHELTERS

- LIMITED FLOWER GARDENS, MORE LOW MAINTENANCE GREEN AREAS
- DOG PARK
- FOUNTAINS/ WATER FEATURES
- TENTS FOR MARKETS
- BLEACHERS, STEPPED SEATING, TERRACES WITH LAWN CHAIRS
- SEATING FOR OUTDOOR CLASSES
- POND FOR MINIATURE BOATS (REMOTE CONTROLLED)
- BOTANICAL DISPLAY
- WATERFALLS, SCULPTURE
- BEACH
- SPLASH PARK
- DANCE AREA
- BIKE TRAILS
- TRAILS FOR ELECTRIC VEHICLES
- FISH CLEANING STATIONS
- PIERS
- LABYRINTH / MAZE

ACTIVE RECREATION

- SKATEBOARDING PARK, TEEN ORIENTED VENUE
- ZIP LINE
- WINTER TOBOGGANING, SLEDDING
- BASKETBALL CIRCLES
- VOLLEYBALL, SAND VOLLEYBALL
- WHITEWATER RAFTING, CANOEING AND KAYAKING
- PADDLE BOATING
- BMX BICYCLE PARK

LODGING

- HOTELS
- RIVERBOAT HOTEL
- BED AND BREAKFASTS, INNS
- UPPER LEVEL REUSE OF DOWNTOWN BUILDINGS
- COTTAGES

FOOD

- WATERFRONT RESTAURANTS
- RESTAURANTS ON BARGES IN THE WATER
- PORTABLE FOOD VENDORS AREA
- FARMERS MARKET
- FOOD TRUCKS / TRAILERS

OTHER COMMERCIAL DEVELOPMENT

- SMALL RIVERBOAT CASINO
- TOURIST SHOP
- BAIT SHOP
- BIKE RENTAL
- BOAT CANOE RENTAL
- GAS STATION FOR BOATS
- ANTIQUE STORES / MARKET

EVENTS

- MUSIC CONCERTS
- FESTIVALS
- BOAT RACES
- SCOUT CONFERENCES
- WEDDINGS
- FIREWORKS
- WINTERFEST
- RIVERFEST
- MOREL FEST
- WINTER WONDERLAND
- A DAILY EVENT AT THE SAME TIME EVERY DAY THAT BRINGS ALL TO THE WATERFRONT

OTHER IDEAS

- FLOWER BASKETS ON BRIDGE
- PED BRIDGE AT RAIL BRIDGE
- RENAME ROUTE 71 "THE ROMANTIC ROAD"

ORGANIZING THE POSSIBILITIES



**MAJOR
ANCHORS**

**DETAILS
& SUPPORT
FACILITIES**

**EVENTS
& PROGRAMS**

WHAT CAN FIT ON THE SITE?

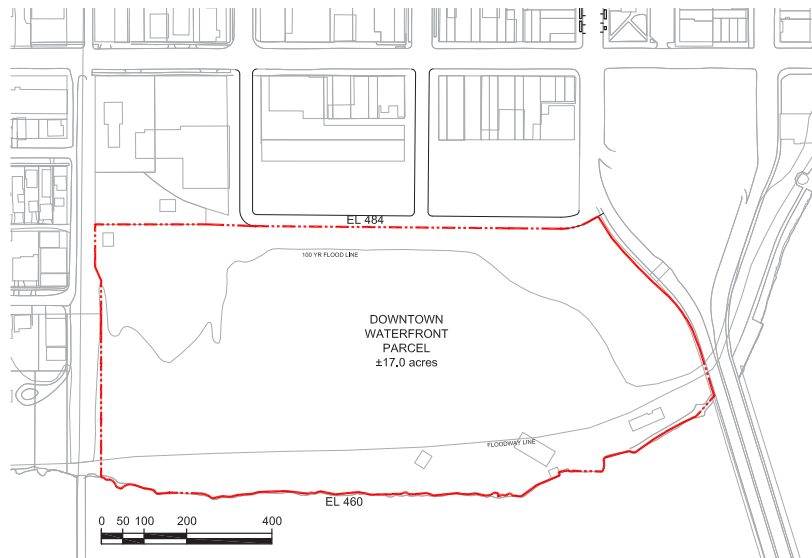

JAY PRITZKER PAVILION



KROC CENTER



AURORA AMPHITHEATRE



HOLLYWOOD BOWL



THE PARK AT ROSEMONT



SPORTSPLEX, ORLAND PARK

AMPHITHEATER AS THE MAJOR ANCHOR

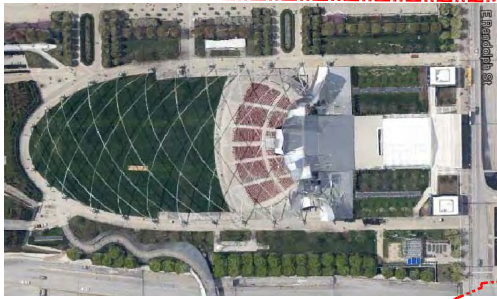

JAY PRITZKER PAVILION



HOLLYWOOD BOWL



AURORA AMPHITHEATRE

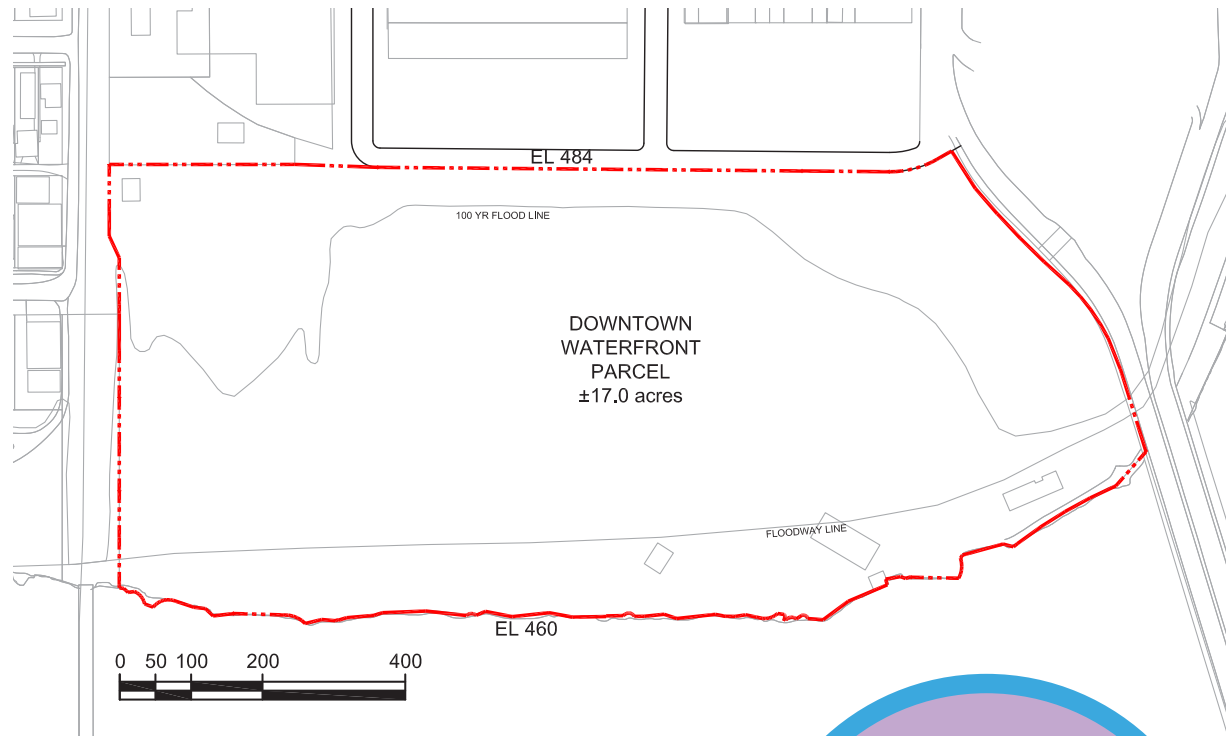

**WHAT
FITS ON
THE SITE?**

AMPHITHEATER AS THE MAJOR ANCHOR

Riverfront Amphitheaters in Communities Comparable to Ottawa

Alliant Energy Amphitheater - Dubuque, Iowa



The Alliant Energy Amphitheater adjacent to the Mississippi Riverwalk and near the American Trust River's Edge Plaza. The Amphitheater faces the restored Star Brewery and is used for special events, festivals and concerts. Rental fees are \$200 per day for private events. Dubuque's population is approximately 58,000.

Vetter Stone Amphitheater -- Mankato Minnesota

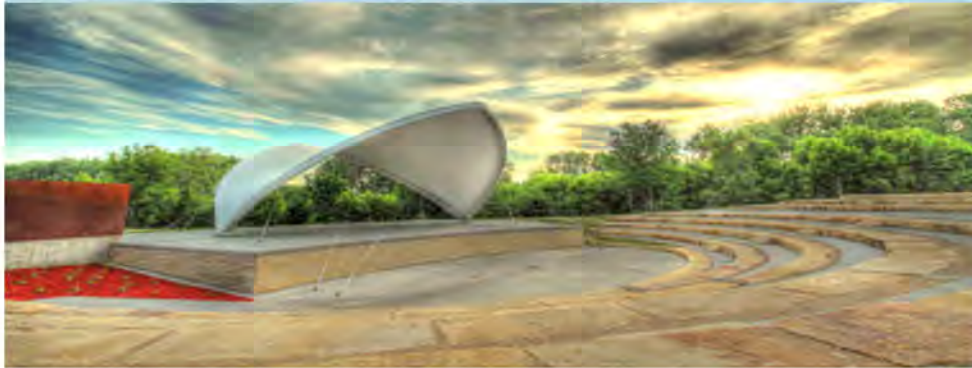

The Vetter Stone Amphitheater is part of the Riverfront Park in Old Town Mankato, Minnesota. Riverfront Park is a 14-acre park that provides riverfront recreation amenities and access to Mankato residents and visitors. With a population of approximately 40,000, Mankato is comparable in size to Ottawa. Some of the Riverfront Park's features include: a playground and fun play equipment for children, educational kiosks, an exhibit featuring poems written by citizens, and access to the river for recreational boating, canoeing, kayaking and fishing. The amphitheater was recently constructed for approximately \$2 million.

Riverloop Amphitheater - Waterloo Iowa



The Riverloop Amphitheater opened in the summer of 2012 and is the last project of Waterloo's River Renaissance Projects. Constructed as a part of the flood wall along the Mississippi River, it has become an important landmark in Waterloo. It has 600 tiered seats and a permanent stage. The amphitheater is adjacent to an arts mall and Mark's Splash Park. Operated by the Waterloo Center for the arts, the venue is booked for weddings, concerts and other public and private events. Waterloo has a population of approximately 68,000.

Alton Amphitheater -- Alton, Illinois



Alton's 4,500 seat Amphitheatre is located near the Argosy Casino and the Alton Marina and is the centerpiece of the ambitious renewal of the Alton riverfront vicinity of this historic town on the Mississippi River. A five dollar Fridays summer concert series features tribute bands. The venue is also available for rentals. Alton has a population 28,000 is 15 miles north of St. Louis.

SHOWCASING POSSIBILITIES



TWO INITIAL CONCEPTS FROM POSSIBILITIES

DOWNTOWN WATERFRONT SITE AT FULL BUILDOUT



PREFERRED SCHEME

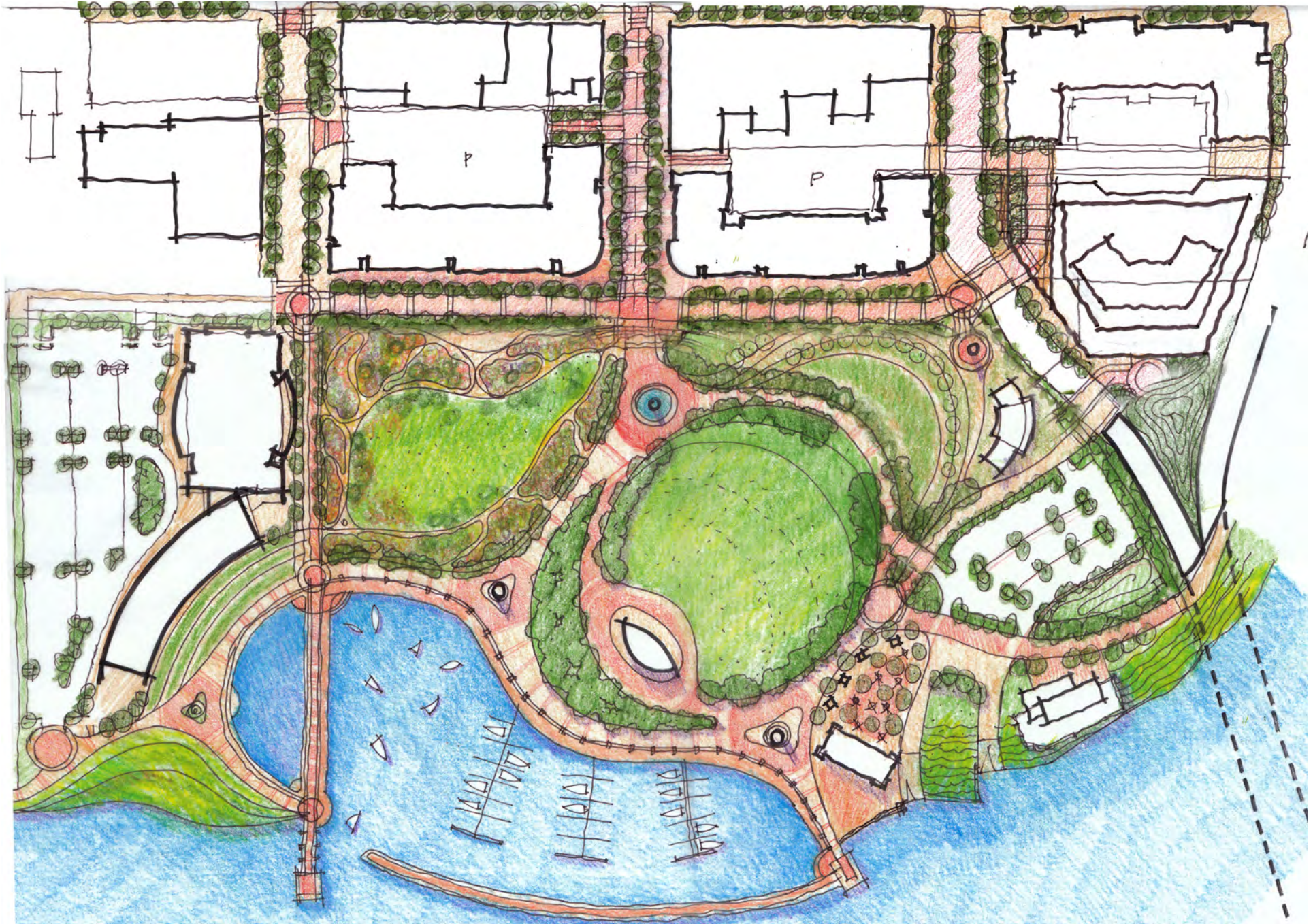

CREATE CLEAR AND VIABLE DEVELOPMENT PARCELS

UNDERSTAND

WHAT IS
PUBLIC,

WHAT IS
PRIVATE,

AND WHAT IS
**A PUBLIC/
PRIVATE
PARTNERSHIP**

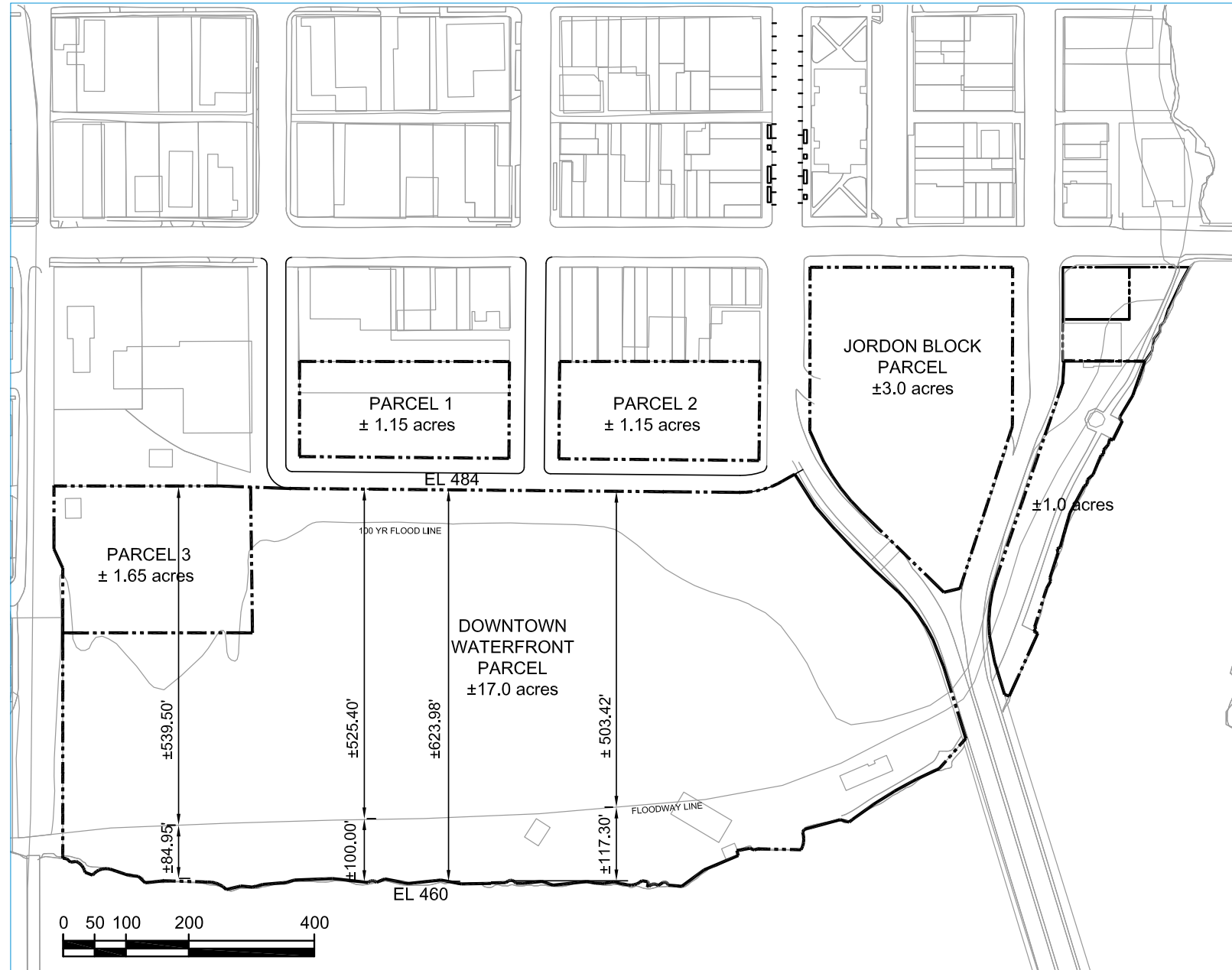

REVISED SCHEME

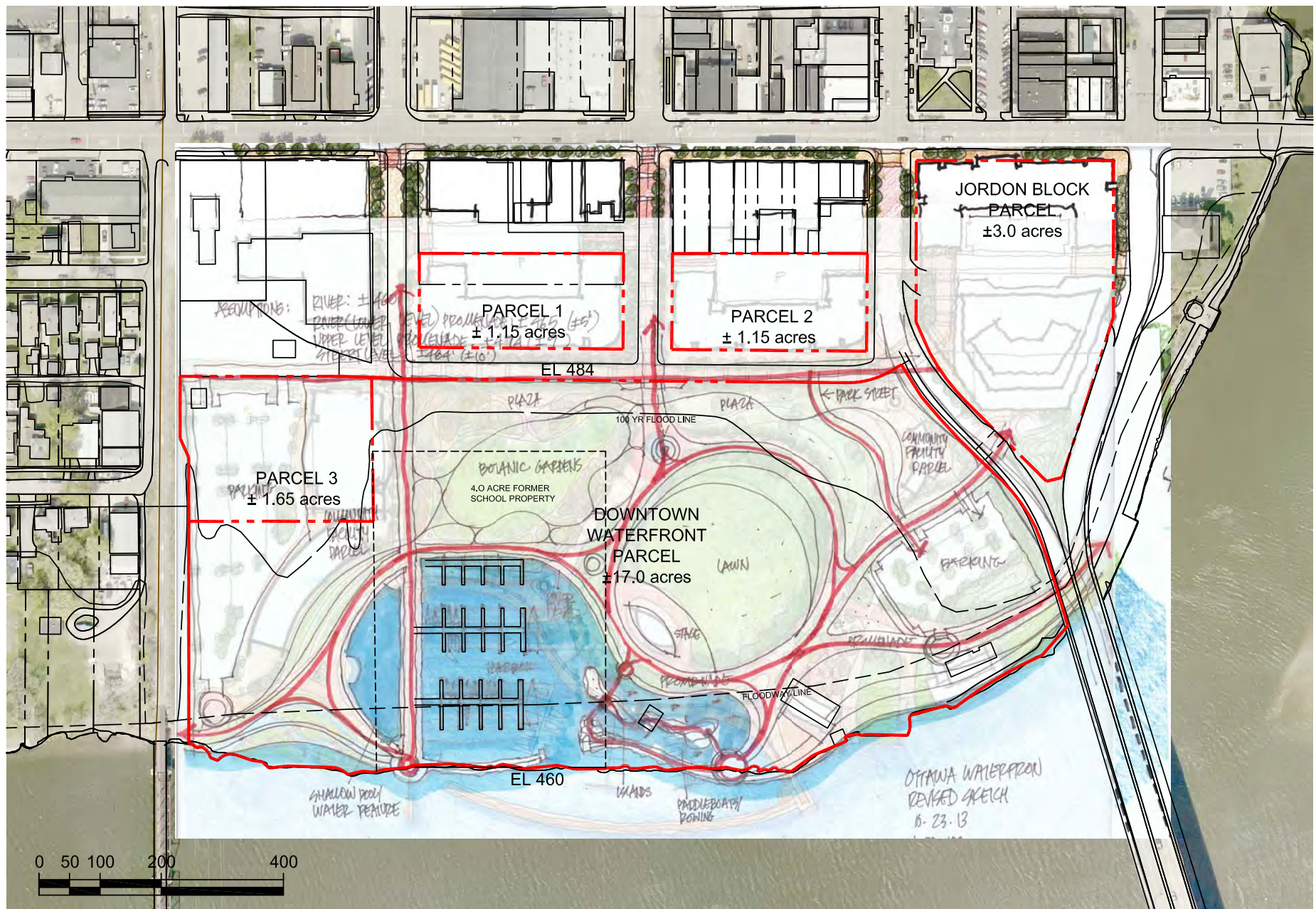

OTTAWA DOWNTOWN WATERFRONT DRAFT CONCEPT SKETCH 2 - REVISED

PREPARED BY: GINKGO PLANNING & DESIGN, INC.



DATE: 10-28-13

MASTER PLAN CONCEPT



WATERFRONT SECTIONS

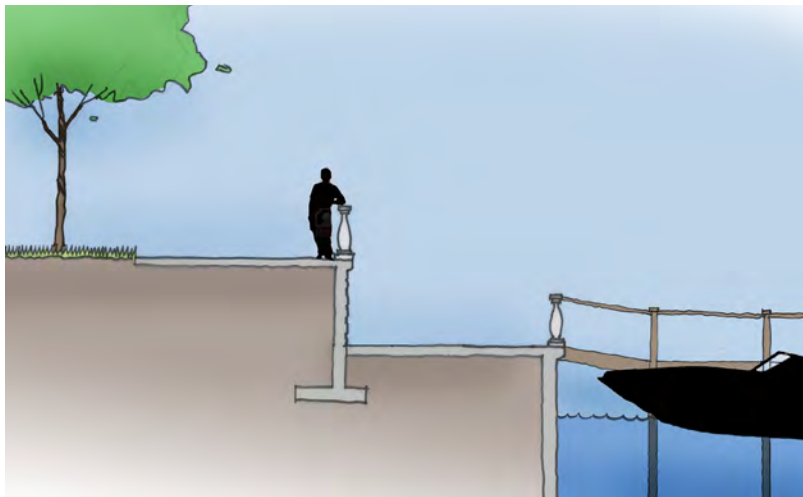

Section A

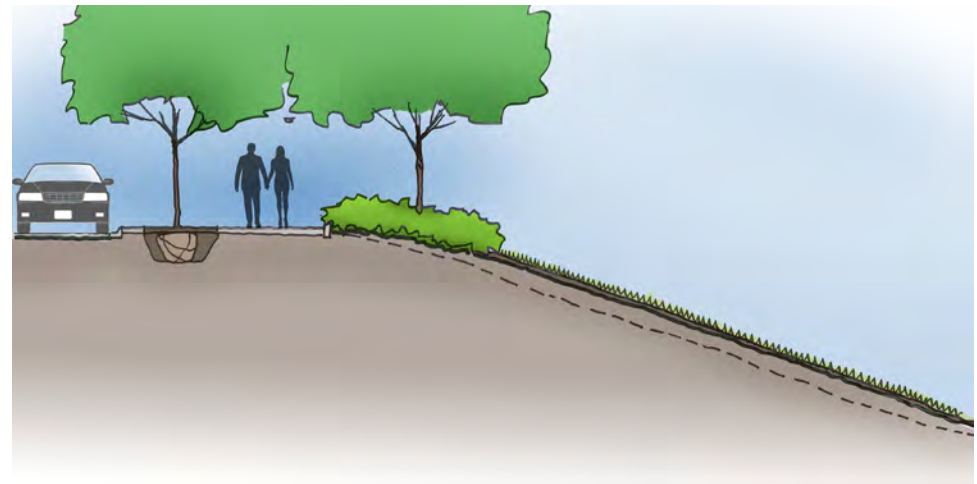

Section B

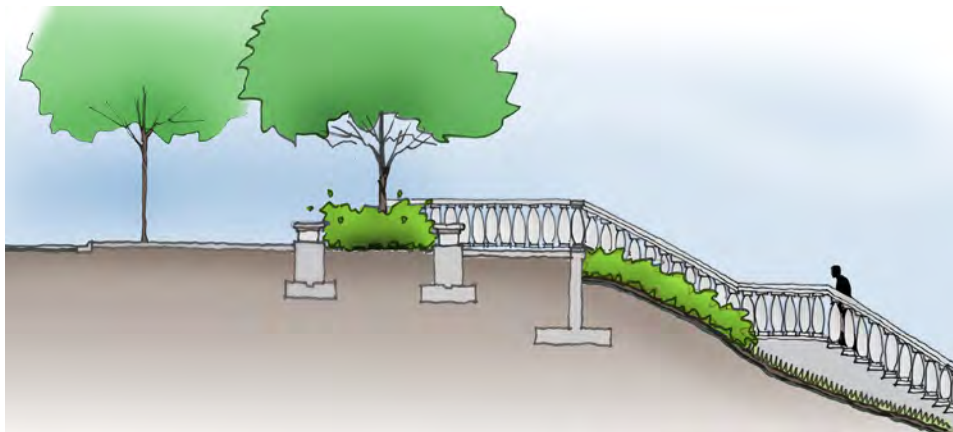

Section C

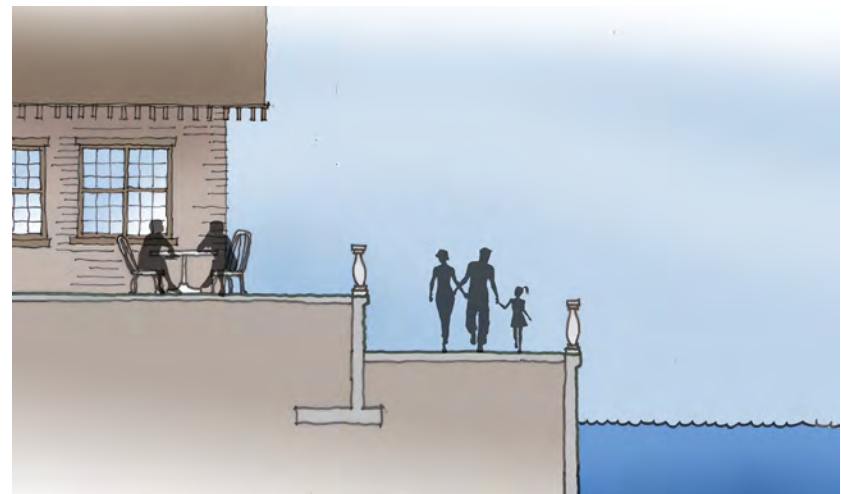

Section D

BOARDWALK CONCEPT



BOARDWALK SECTIONS

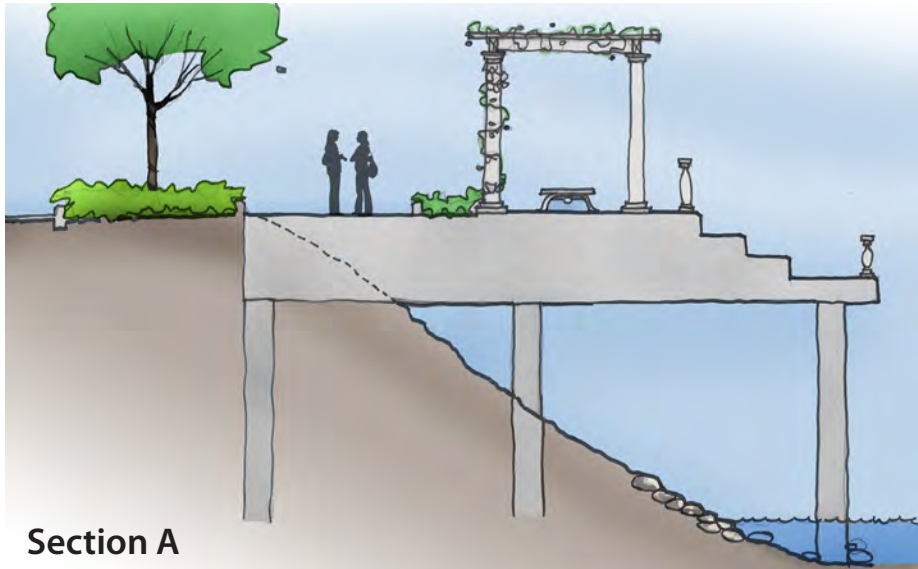

Section A

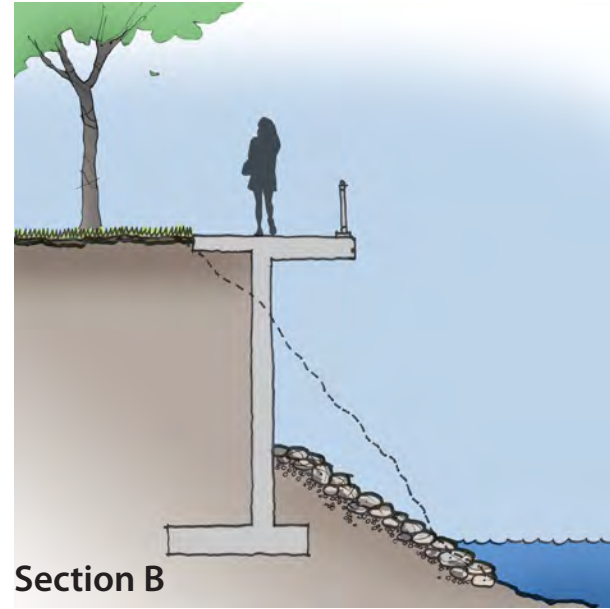

Section B

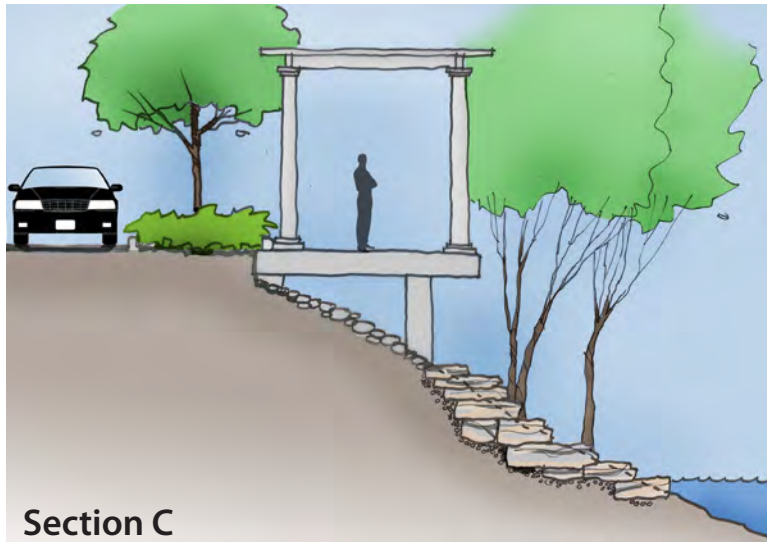

Section C



Ottawa Waterfront Sections
City of Ottawa Comprehensive and Downtown Plan Update
Ottawa, Illinois

SCALE: 1/4" = 1'-0"
0' 4' 12'
ISSUE DATE: November 26, 2013
PROJECT NUMBER: 03-1030-001
All drawings are preliminary and subject to change.
© 2013 Hitchcock Design Group

PREPARED FOR:
City of Ottawa
IN ASSOCIATION WITH:
Ginkgo Planning and Design

POSSIBILITIES

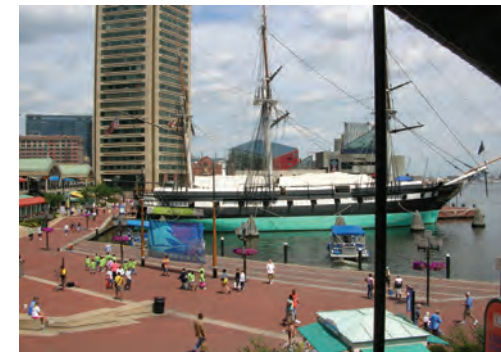

POSSIBILITIES

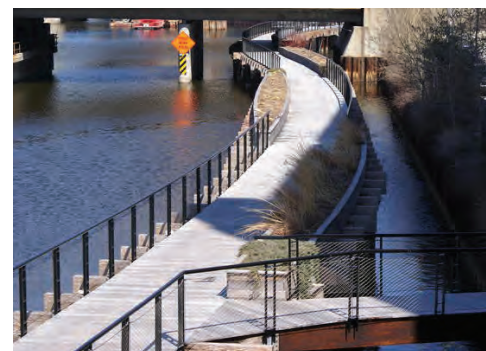

MASTER PLAN CONCEPT



PARKING



**OVER 1,000
SPACES AT THE
WATERFRONT**

**POSSIBLE
GARAGE ON
JEFFERSON ADDS
ABOUT 150
SPACES**

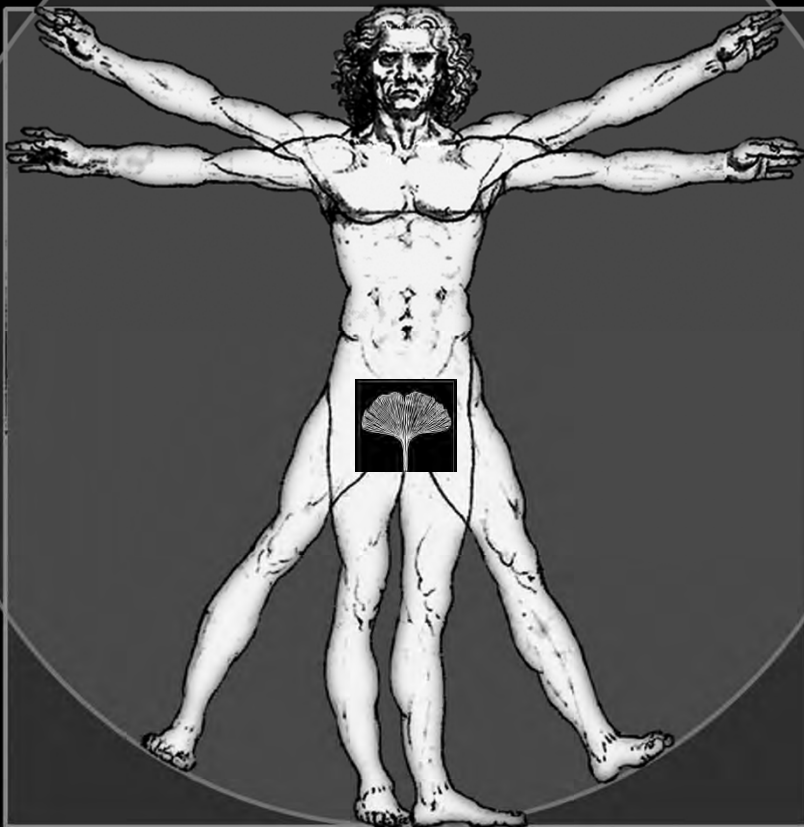

Human Scale.

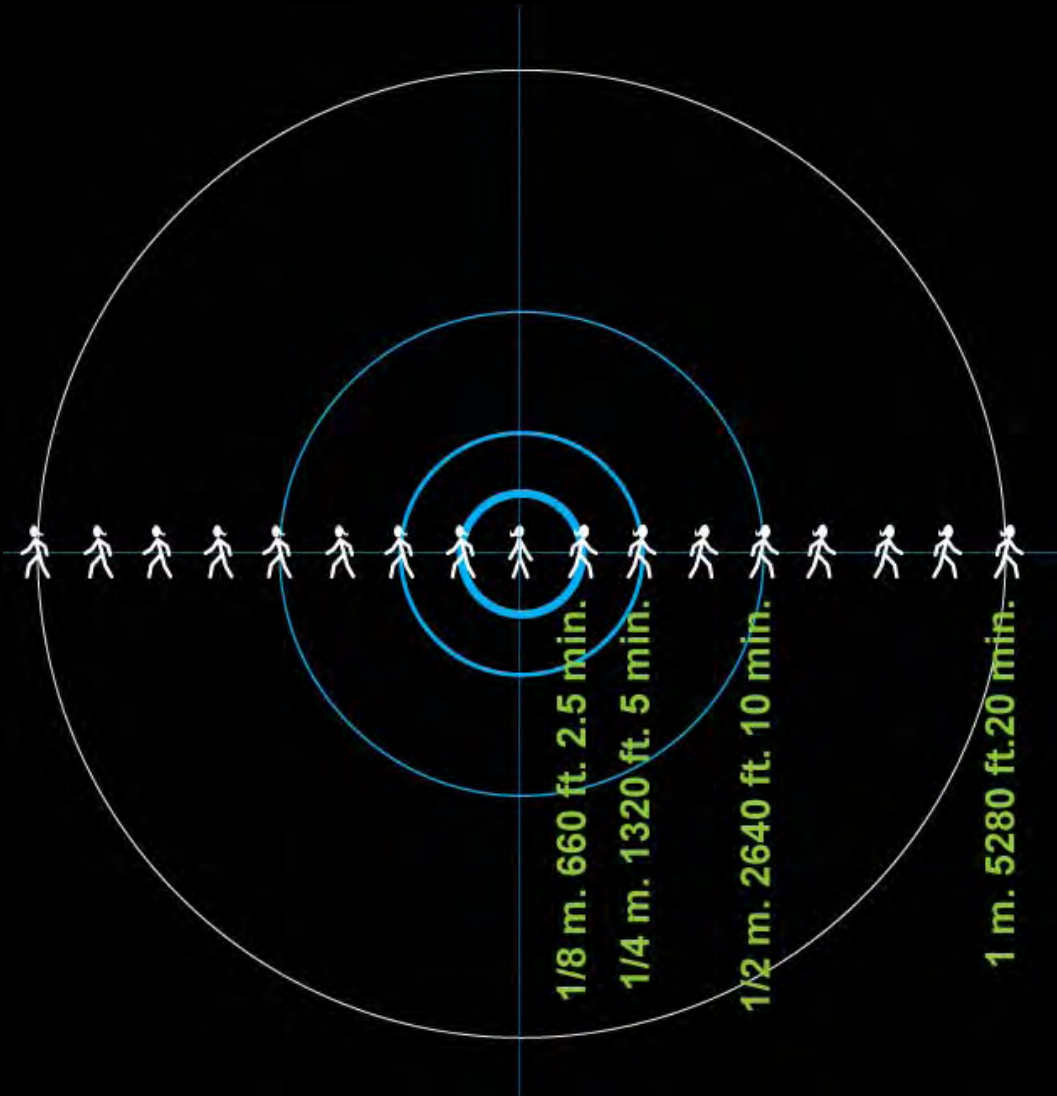

Walking Scale.



Entire **Downtown Ottawa**
and **Chicago Loop** fits in
about 64 blocks
½ mile walk circle
10 minute walk circle

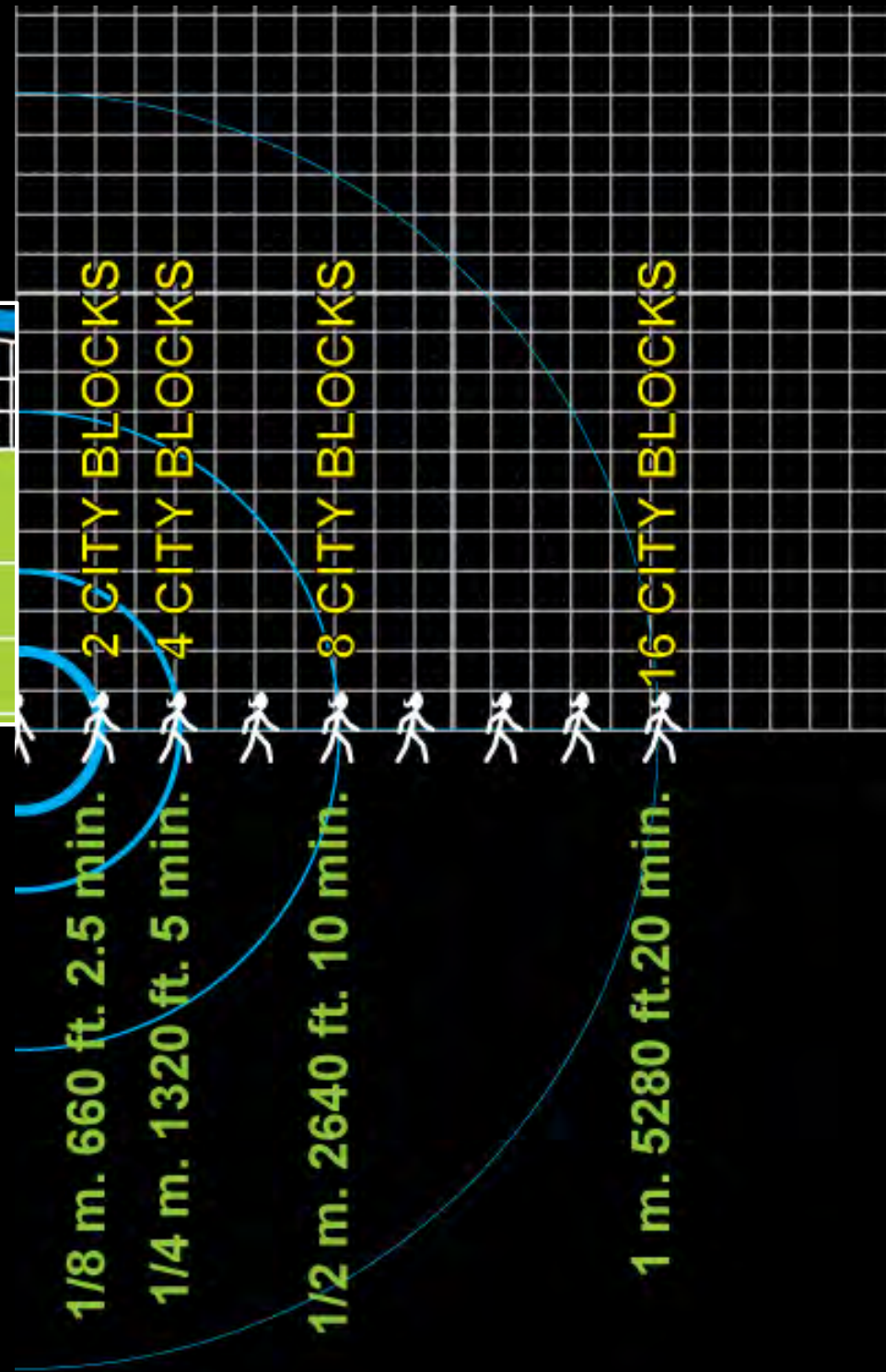

The Mall and the Main Street

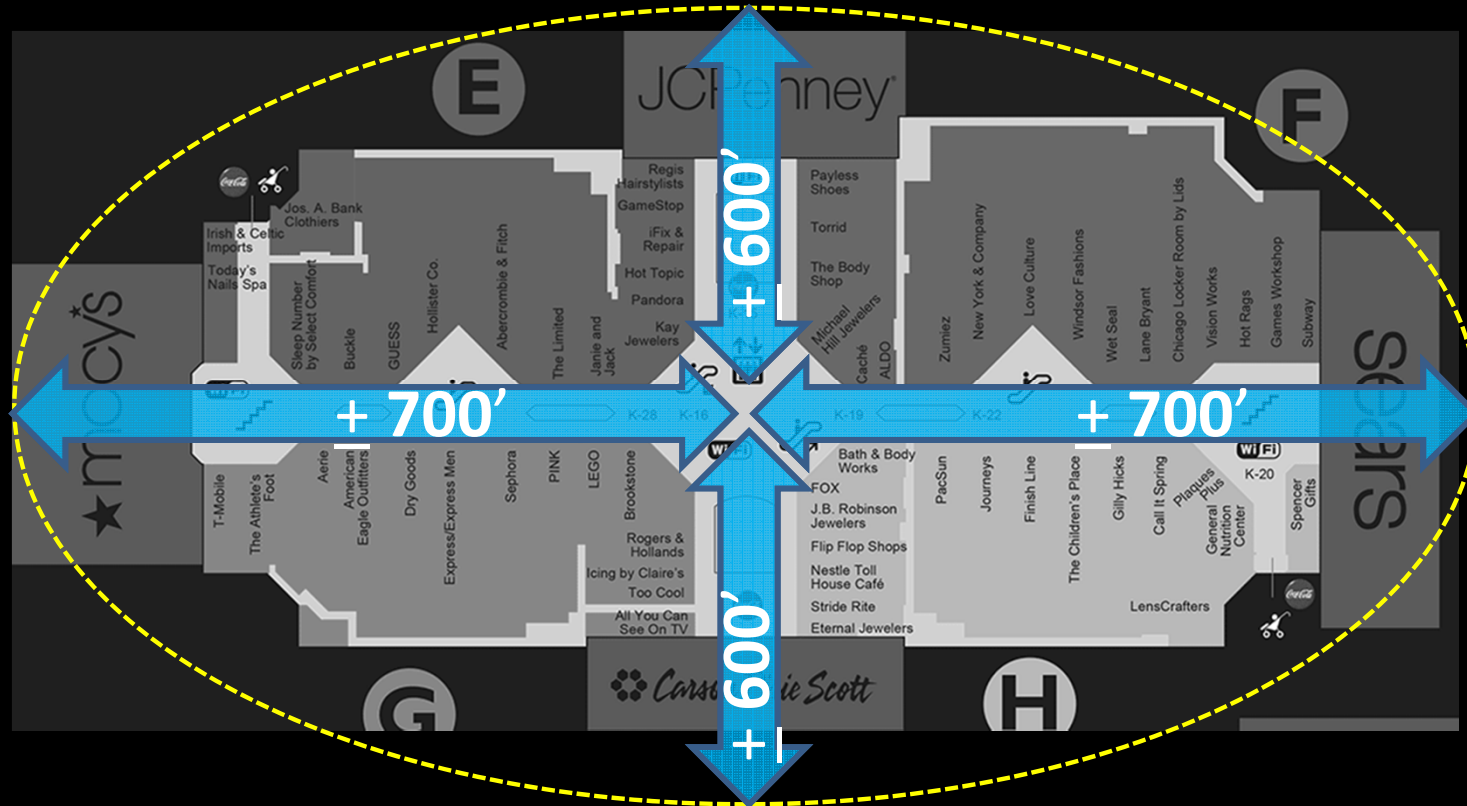

1. Get people to PARK ONCE
2. Make them WALK between ANCHORS
3. TWO PEDESTRIAN CORRIDORS at right angles
4. All within a quarter mile or 5 minute walk from any two points.

PARKING



**OVER 1,000
SPACES AT THE
WATERFRONT**

**POSSIBLE
GARAGE ON
JEFFERSON ADDS
ABOUT 150
SPACES**

Downtown Indianapolis Canal





Richmond Riverfront, VA



Richmond Riverfront, VA



Richmond Riverfront, VA

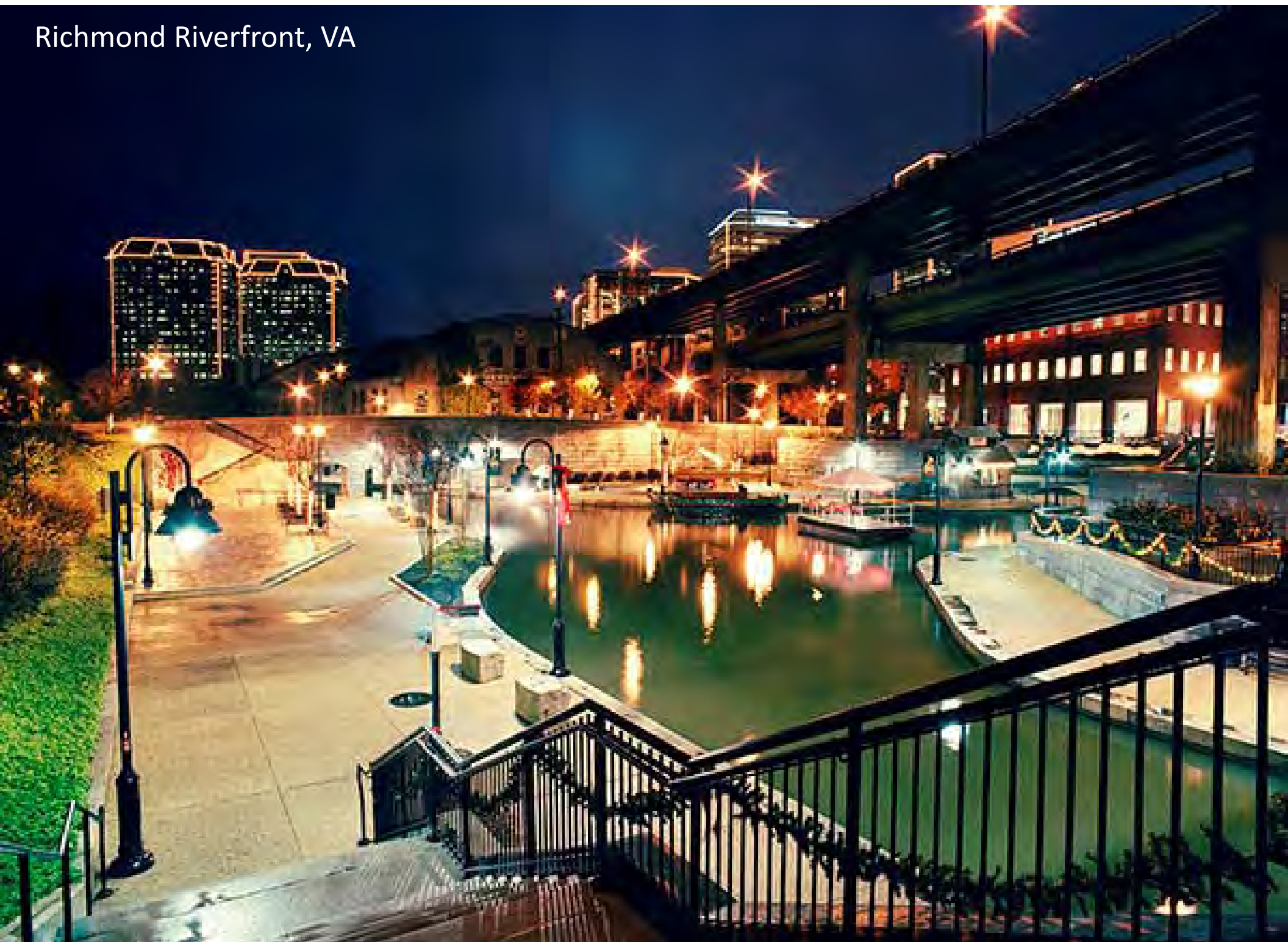

ONE DOWNTOWN EXTENDING TO THE WATERFRONT



Downtown District Map

Exhibit 2



The map displays the downtown area of St. Ignace, Michigan, with a grid of streets. The streets shown include Chestnut St., W. Joliet St., W. Superior St., W. Washington St., W. Lafayette St., W. Jackson St., W. Jefferson St., W. Main St., and Courtney St. A red dotted line outlines a large area, and a green line outlines a smaller area within it. A large, detailed illustration of a park with a lake, walkways, and buildings is shown in the bottom left corner.

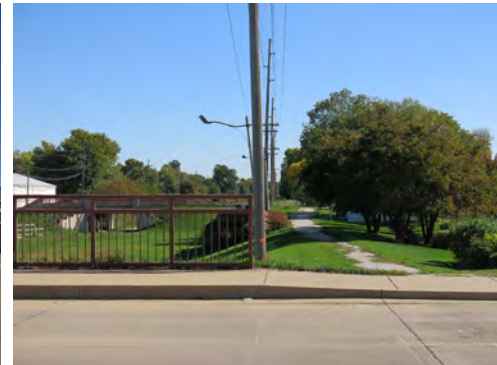

A NEW CANAL TO REVITALIZE A DOWNTOWN

Bricktown Canal Oklahoma City, OK

The Bricktown Canal opened July 2, 1999 and was an instant hit with Oklahoma City residents. The canal was seen as the most frivolous of the nine Metropolitan Area Projects when the initiative was passed by voters in 1993. And when it opened the canal was primarily surrounded by empty old warehouses north of Reno Avenue, and just dirt south of Reno. A decade later the area is dramatically different. Most of the warehouses have been renovated and the waterway is lined with a hotel, theater, shops, a bowling alley, restaurants, clubs and offices.



**A WELL DEFINED &
CONNECTED DOWNTOWN**

**FROM THE CANAL
TO THE NORTH**

**TO THE WATERFRONT
TO THE SOUTH**

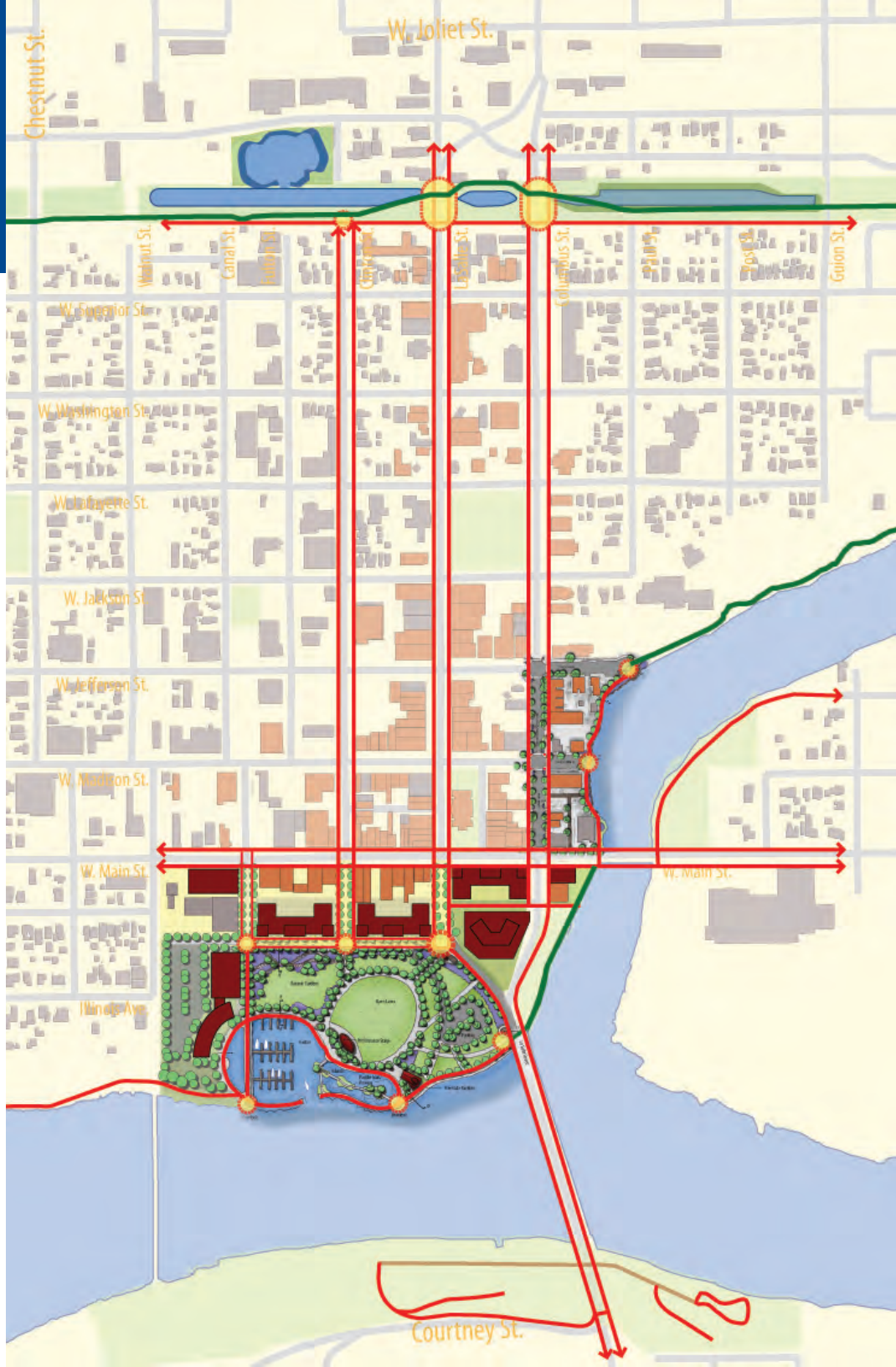

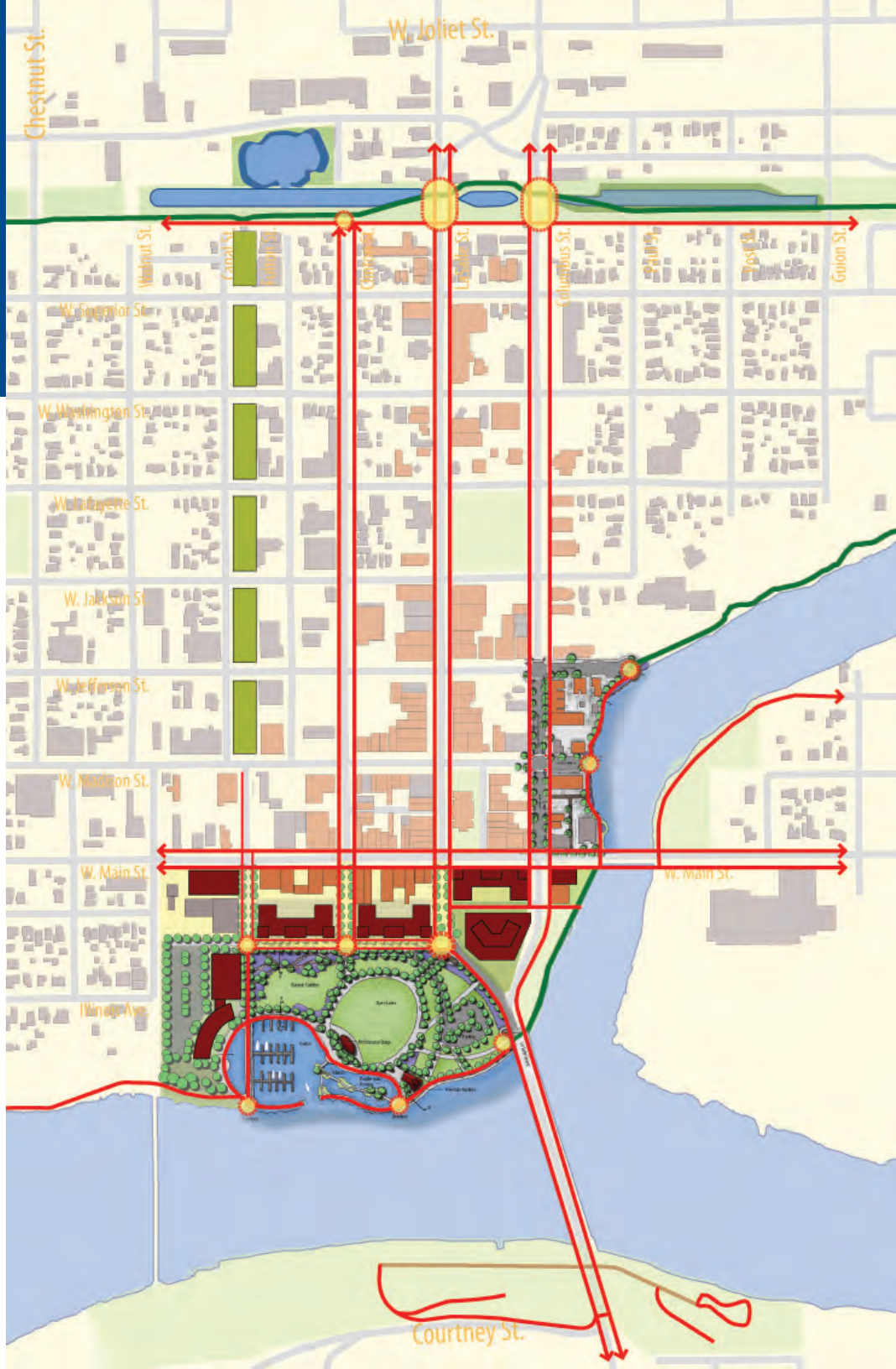

A NEW PARK ALONG CANAL STREET TO REVITALIZE THE WEST PART OF DOWNTOWN



THE HISTORIC CANAL ALONG CANAL STREET

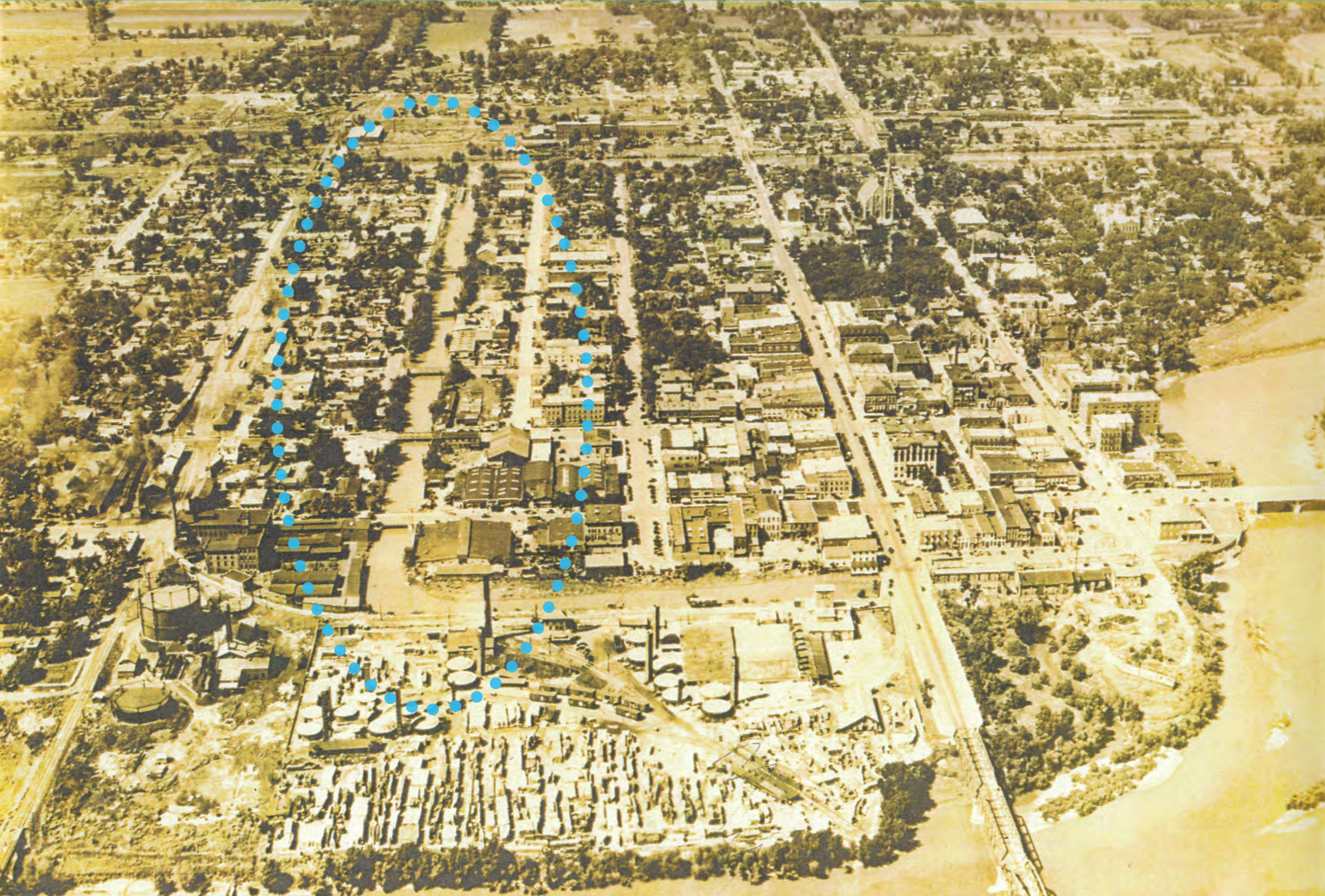

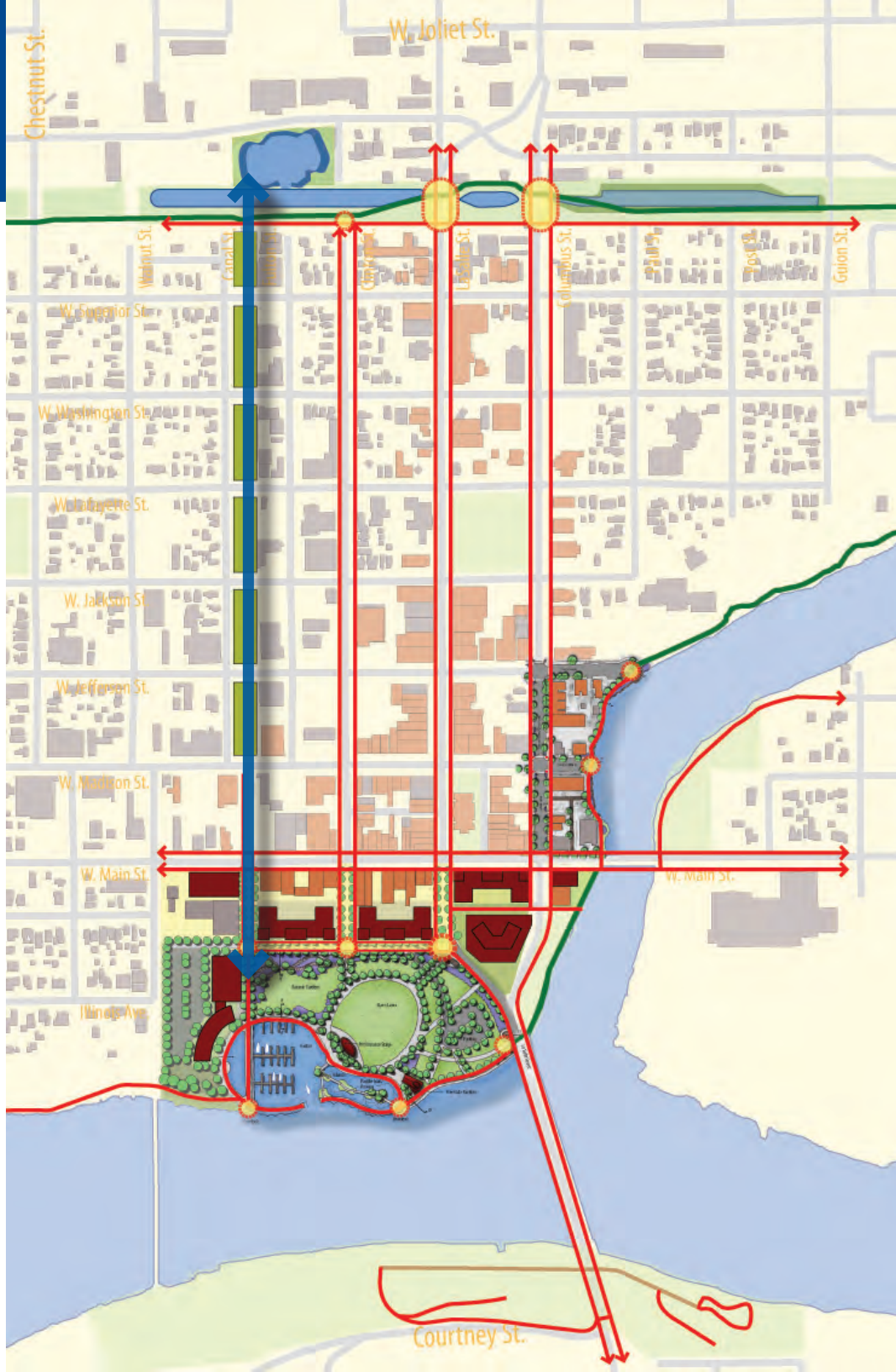

POSSIBILITIES

A LINEAR PARK

A LINEAR WATER FEATURE

A FULLY RESTORED CANAL

BRINGING NEW DEVELOPMENT ALONG THE CANAL PARK

**NEW SMALL
RESTAURANTS & SHOPS**

**NEW HOUSING:
ROWHOUSES
CONDOS
VACATION HOMES ETC.**



A WELL DEFINED AND CONNECTED PUBLIC REALM FRAMEWORK

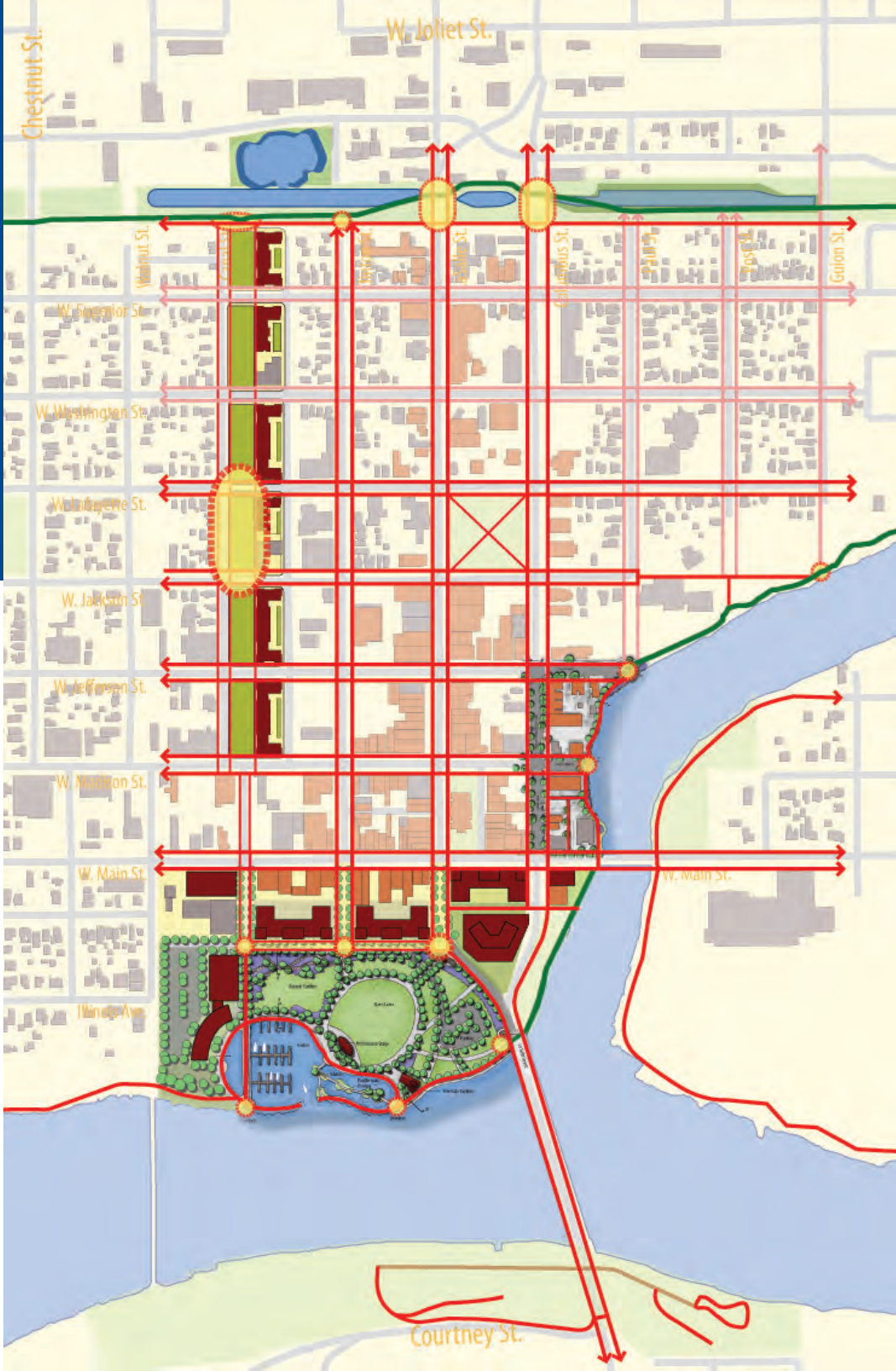

WATER TRAILS

CONNECTING DOWNTOWN TO OTHER DESTINATIONS



[illegible]

SUB DISTRICT AREA

MARQUETTE STREET DISTRICT OPTIONS



MARQUETTE STREET DISTRICT AREA

MARQUETTE STREET DISTRICT OPTIONS

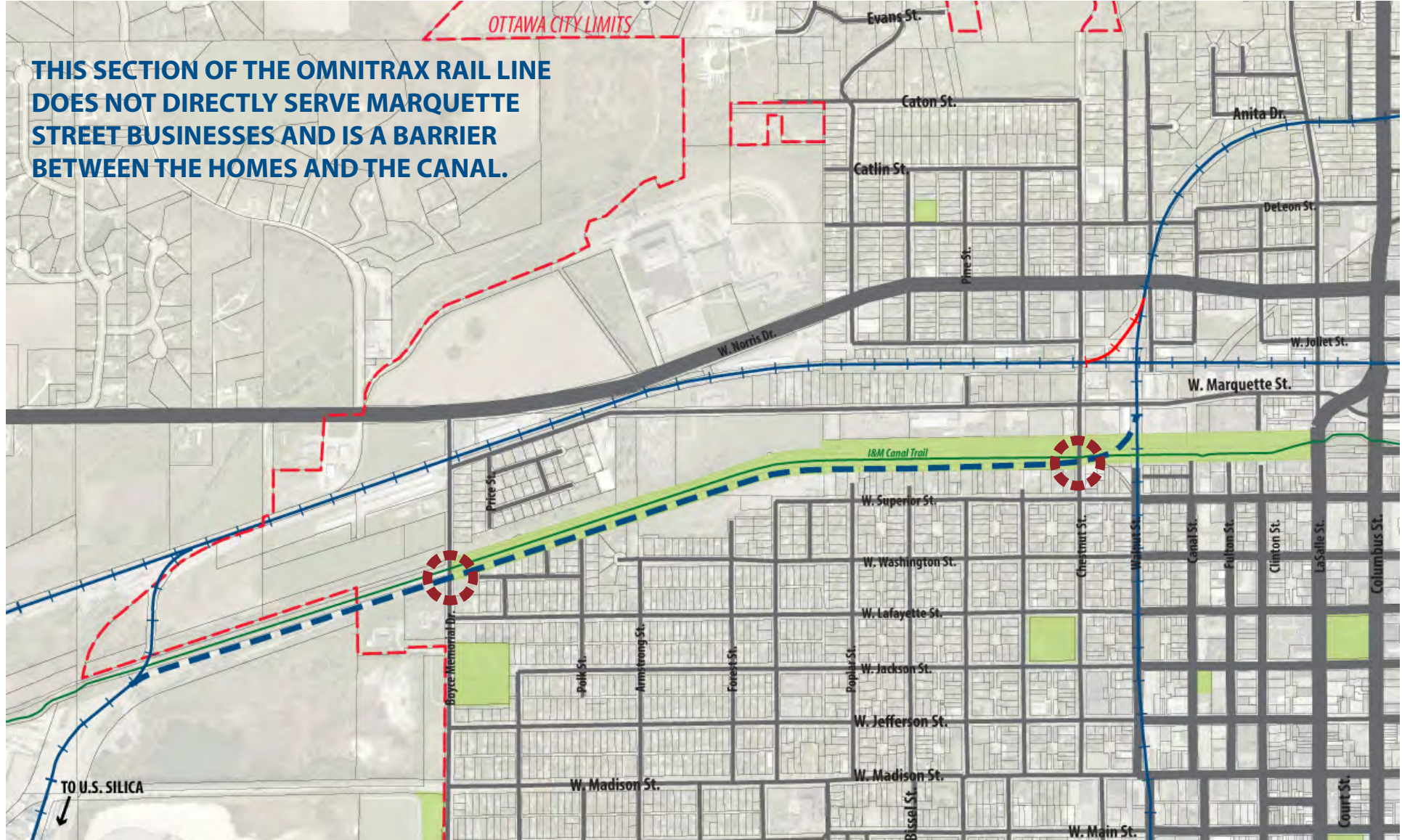

1. REMOVE OMNITRAX RAIL SPUR FROM MAINLINE TO JUNCTION WITH CSX
2. CONNECT OMNITRAX WITH CSX TO SERVE U.S. SILICA
3. TWO EXISTING GRADE CROSSINGS CAN BE ELIMINATED

— — — — — RAIL SPUR SECTION TO BE REMOVED

+++++ NEW RAIL CONNECTION

⊗ EXISTING GRADE CROSSINGS TO BE ELIMINATED

MARQUETTE STREET DISTRICT OPTIONS

Environmental condition of the area will not likely be easy to get to residential standards. Commercial and industrial end uses would be easier to handle for the environmental impacts.

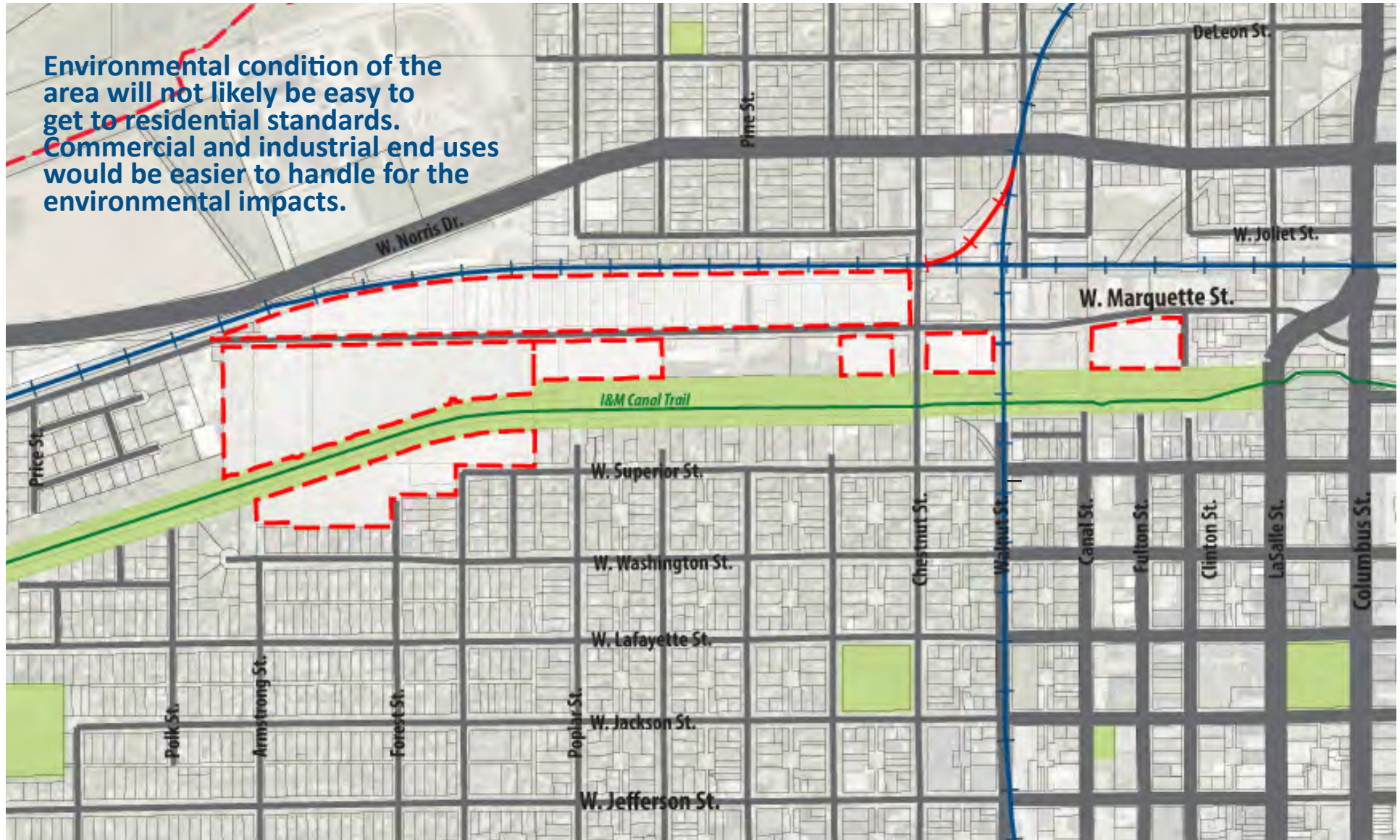

SIGNIFICANT REDEVELOPMENT OPPORTUNITY

MARQUETTE STREET DISTRICT OPTIONS

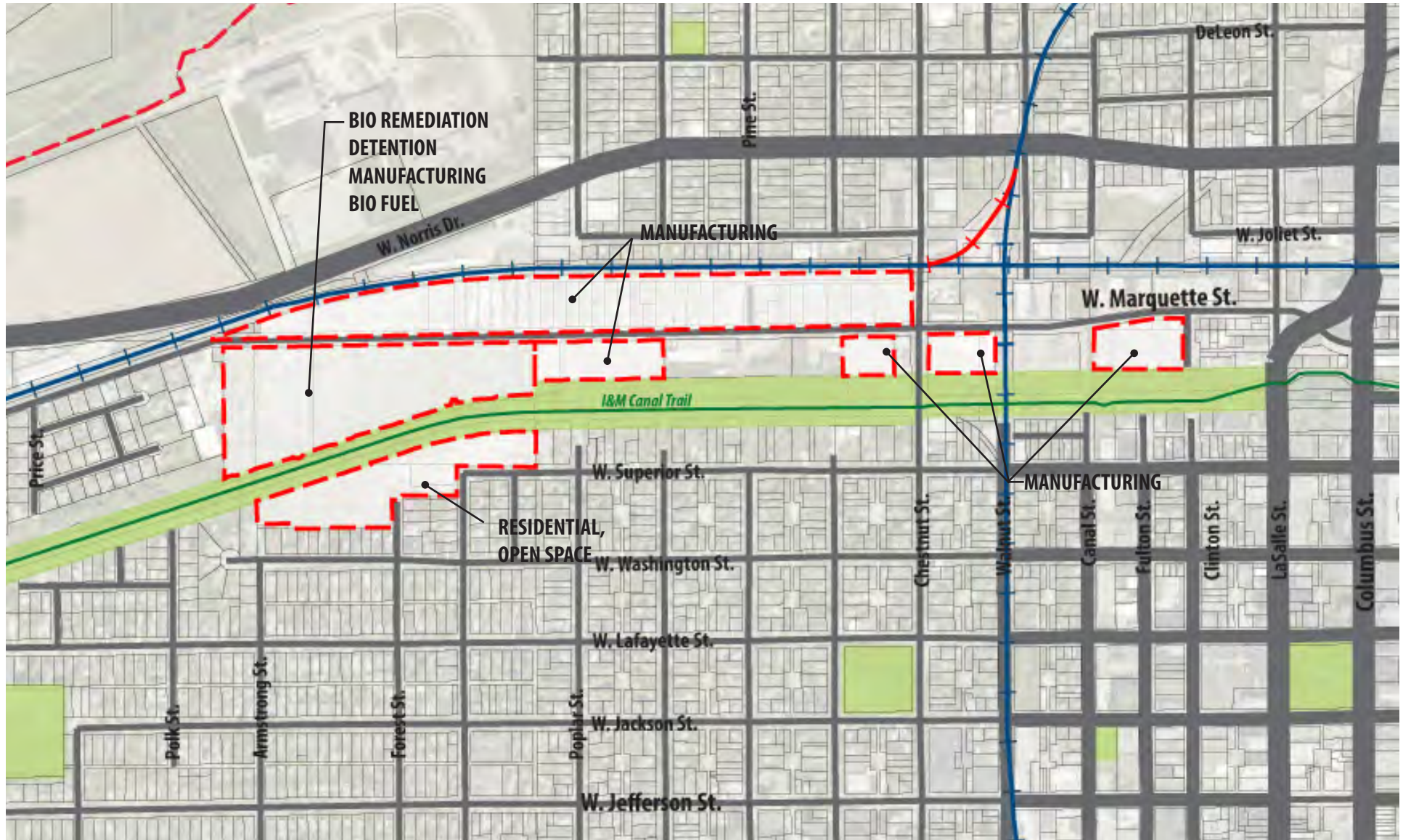

**REDEVELOP WITH A CLEAR IDENTITY AS A MANUFACTURING /
SMALL BUSINESS HUB NORTH OF THE CANAL**

 REDEVELOPMENT
SITES

POTENTIAL ROAD AND PEDESTRIAN CONNECTIONS



1. POTENTIAL TO EXTEND POPLAR ST. SOUTH TO MARQUETTE
2. ESTABLISH GRADE CROSSING WITH CSX TRACKS
3. POTENTIAL FOR ROAD OR PEDESTRIAN CONNECTION TO SUPERIOR ST.



POTENTIAL ROAD
CONNECTION



POTENTIAL ROAD
OR PEDESTRIAN
CONNECTION



POTENTIAL
RAILROAD
GRADE CROSSING

MARQUETTE STREET DISTRICT EXISTING ZONING

Marquette Street Redevelopment Area - Zoning

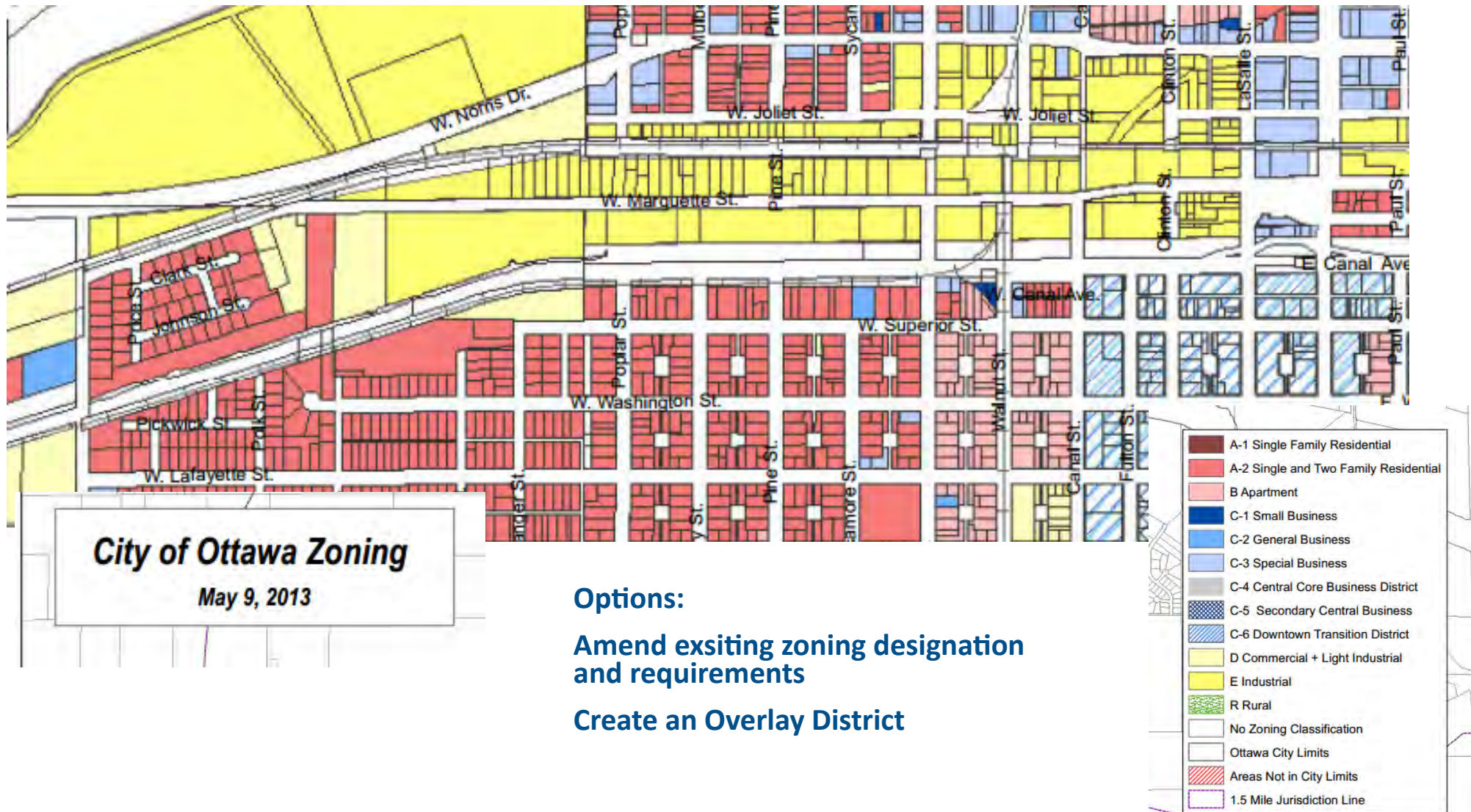

BUILDING ON THE GOALS OF THE LAST DOWNTOWN PLAN

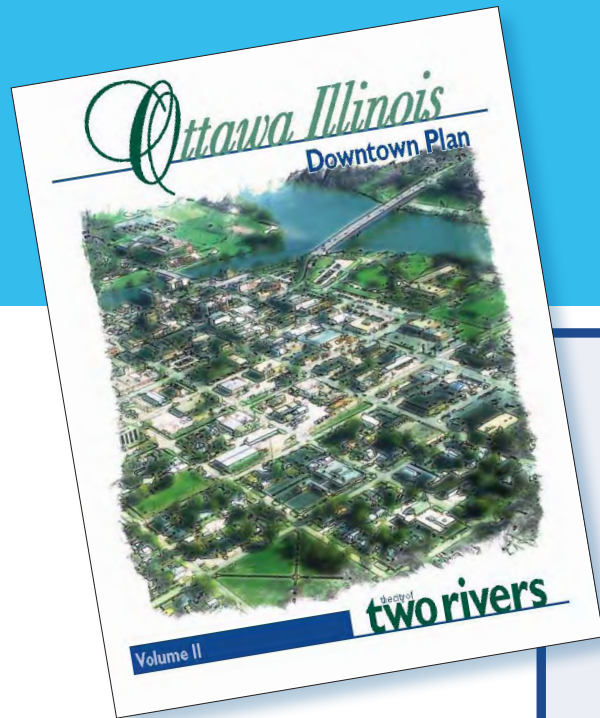

Revitalize and preserve Ottawa's downtown architectural heritage and traditional downtown atmosphere

Encourage a vibrant cultural atmosphere and public involvement in downtown

Promote public and private investment in the future of downtown

Reinforce the sense of historical continuity and unique character and setting of downtown Ottawa

Increase and promote residential uses in Ottawa's downtown

BUILDING ON THE GOALS OF THE 2008 BRANDING PLAN



Ottawa's Brand Promise

Green and glorious, the new Ottawa has emerged as a gardener's paradise, a regional centerpiece for the botanical arts. Once the western frontier of our nation, then a vital transportation and manufacturing link in the Midwest, Ottawa now stands as a premier destination for the traditions and practical art of gardening.

Ottawa's historic downtown and its architecturally beautiful buildings have been transformed into an engaging botanical experience showcasing the aesthetic pleasures of plant life in its many forms. The waterfront invites a meander, with its beautiful English-inspired greenhouse, while the downtown features unique signature shops and original restaurants showcasing organic produce along the tree-lined streets shimmering with springtime blossoms. Here you can also learn from Master Gardeners, watch skilled craftsmen create outdoor art from glass, iron and clay, or just amble through the Farmer's Market for the best produce the region has to offer.

Each season Ottawa brings new gardening experiences to life - whether it is to shop for specialty tools and supplies amid the fragrances of spring and summer, enjoy the fall harvest celebration, or experience the dazzling light displays during the winter - all the while learning how to prepare your garden for the next season. Ottawa surprises and delights gardeners, young and old, throughout the year.

The Brand Promise (the one sentence version)

Ottawa showcases the world of plants and the joy of gardening in a pedestrian setting of engaging attractions and activities.



REGIONAL TOURISM DESTINATIONS



NEW GOALS OF THE 2013 PLAN

**POSITION DOWNTOWN
OTTAWA AS A MAJOR
TOURISM DESTINATION IN
THE REGION**

**A LIVABLE CITY TO
ATTRACT AND RETAIN
NEW WORK FORCE AND
EMPLOYERS**

2013 COMPREHENSIVE PLAN AND DOWNTOWN PLAN UPDATE

CITY OF OTTAWA, IL

THIRD PUBLIC FORUM DECEMBER 4, 2013

NEXT STEPS

**JANUARY
DRAFT PLAN**

**PLAN
COMPLETION
IN SPRING**



Welcome to the
City of Ottawa, Illinois



HomeResidentsVisitorsBusinessesGovernment

CITY SERVICES

- Applications, Forms & Permits
- ADA Compliance
- Boards & Commissions
- Boards & Commissions Agendas & Minutes
- Census
- Character Counts
- City Council
- City Council Agendas, Minutes & Videos
- City Directory
- Combined Sewer Overflows (CSO)
- Community Development
- Economic Development
- Electric Aggregation
- Education
- Finance
- Fire/Police Department
- LaSalle County
- Legislature
- Maps
- Mini Bus/Taxi/Parking
- Municipal Codes
- Parks
- Recreation
- Reddick Library
- Streets
- Transportation
- Utilities
- Water
- Waste Water

Welcome to the City of Ottawa, Illinois!

Visitors to Ottawa soon discover why it was one of the first great cities to sprout from the Illinois Prairie. Located in a beautiful valley at the confluence of the Fox and Illinois Rivers ... [read more](#)



Mayor Robert M. Eschbach

LATEST NEWS

Ottawa Community Garden

Ottawa Comprehensive Plan & Downtown Plan Update

First and Second Public Forum

Comments & Presentations



[Hydrant Flushing 2013](#)

[Leaf Vac Schedule 2013](#)

2013 SANTA'S HOURS

SANTA'S VISITING HOURS